

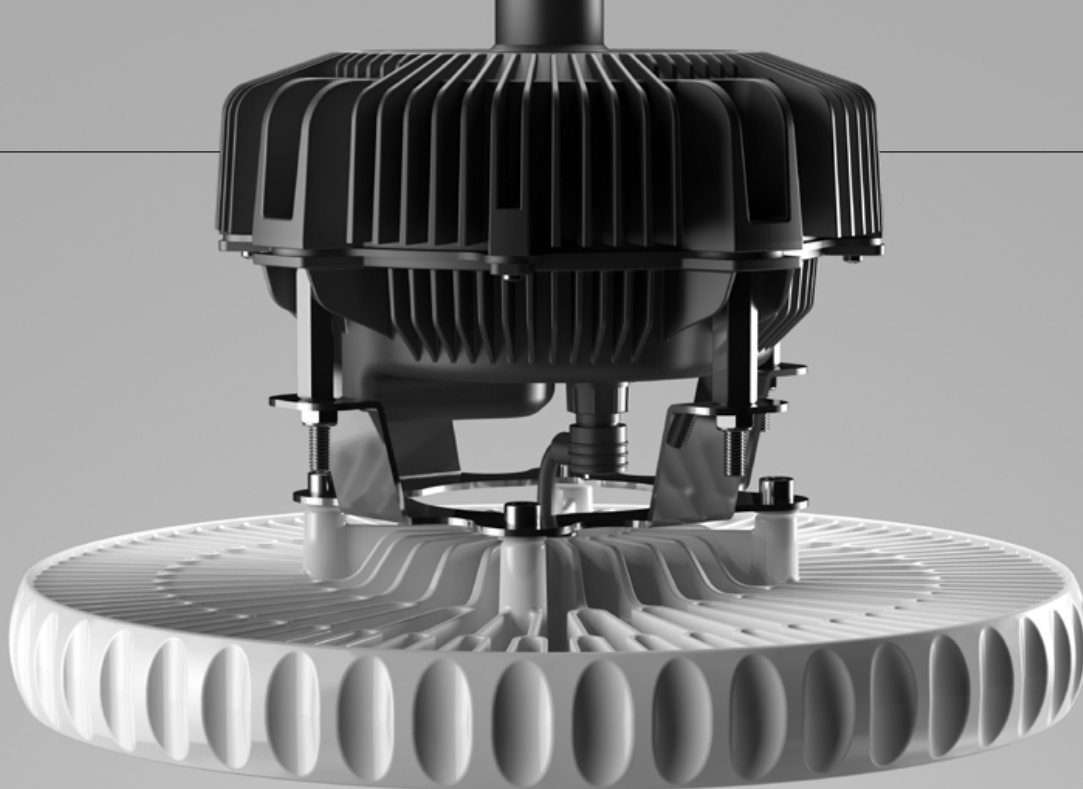

# IBYS-DALI

LED HIGHBAY HBY-IBYS DALI





The IBYS DALI represents a revolutionary change in architectural and commercial high bay lighting.

Available in 160W or 240W, and completed with integral Dali Driver, the IBYS DALI is designed as a highly efficient and adaptable replacement of industry standard gas discharge lamps of up to 250W/400W. The IBYS DALI is offered in array of colour temperatures as well as high CRI versions for the most discerning architectural applications.

It's incredibly sleek, yet robust design allows it to be used in a wide variety of applications, ranging from heavy industrial facilities through to retail stores, shopping centres, stadiums and public spaces.



#### POWER

#### LUMINOUS FLUX

##### 160W

160W at 25°C

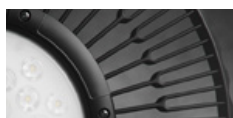

15,670 – 16,900 lm

##### 240W

250W at 25°C



16,065 – 23,136 lm

#### COLOUR TEMPERATURE

2700K

3000K

4000K

5000K



## OPTICAL VARIATIONS

The IBYS DALI is offered in a range of optical variation, offering precision, colour consistency and a high CRI for each particular application.

## ENGINEERED TO PERFECTION

Over 100 lm/W efficiency. Low power consumption. Long life endurance. Inbuilt DALI control. The IBYS DALI is everything you could possibly wish for in a high bay.



L70

### LONG USEFUL OPERATING LIFE

Currently available specification from world's most reputable LED manufacturers states 50,000 hours of continuous operation at the rated current within the operating temperature range to 70% residual light output.



### VARIOUS CCT & COLOUR BINNING CONSISTENCY

Product is offered in various Colour Temperatures using tighter bins.

5 YEARS

### 5 YEARS WARRANTY

Coolon Luminaires are covered by a solid comprehensive manufacturer's warranty that covers a range of possible defects and performance parameters throughout the duration of the warranty period.



### PROUDLY MADE IN AUSTRALIA

Our products are designed and manufactured in Australia. Engineered to perfection, using only the highest quality components and highly skilled labour, each luminaire is assembled and thoroughly tested to ensure that it exceeds the highest standards.

## ■ TECHNICAL SPECIFICATIONS

	IBYS DALI-160 (CRI 80)		IBYS DALI-240 (CRI 80)	
CCT	2700K		2700K	
	3000K		3000K	
	4000K		4000K	
	5000K		5000K	
	IBYS DALI-160 (CRI 90)		IBYS DALI-240 (CRI 90)	
CCT	2700K		2700K	
	3000K		3000K	
	IBYS DALI-160		IBYS DALI-240	
Luminous Flux (Photometered)	15,670 – 16,900 lm		16,065 – 23,136 lm	
Luminous Flux (LED Lumens)	20,863 lm		23,520 lm	
Power Consumption	160W at 25°C		250W at 25°C	
Nominal Voltage	230VAC			
Voltage Range	90 – 305VAC			
	127 – 431VDC			
Frequency Range	47 – 63Hz			
Power Factor	>0.95 / 230VAC			
Leakage Current	<0.75mA / 277VAC			
Cable Type	Standard 3 Core Flex with 3 pin Au Plug			
Cable Length	1.5m			
IP Rating	IP65			
Operating Temp. Range	-20 – 55°C			
Thermal Management Type	Active / Continuous			
Expected Lifespan	50,000 Hours to 70% Brightness			
Material Composition (Body)	Aluminium Alloy			
Angle Adjustment	+/- 60° (IBYS-WMB)		+/- 60° (IBYS-WMB)	
Weight/Packaging	Luminaire	Packaging	Luminaire	Packaging
IBYS-HKM	4.2 kg	6.3 kg	5.2 kg	6.8 kg
IBYS-WMB	4.3 kg	6.4 kg	5.3 kg	6.9 kg
Packaging Dimensions	360 x 360 x 300mm			
Warranty	3 – 5 Years (3 years warranty as standard. 5 years extended warranty optional.)			

### Compliance (Safety Standards)

AS/NZS60598.1	Luminaires - General Requirements and Tests
AS/NZS 60598.2.1	Luminaires - Particular requirements - Fixed general purpose luminaires
UL 1598 and CSA C22.2 No. 250.0-08	Luminaires
UL 8750	Standard for Light Emitting Diode (LED) Equipment for use in Lighting Products

### Compliance (EMC)

AS/NZS CISPR15	Limits and methods of measurement of radio disturbance characteristics of electrical lighting and similar equipment
FCC Part 15 Subpart B	Class B limits
ANSI C63.4-2009	American National Standard for Methods of Measurement of Radio-Noise Emissions from Low-Voltage Electrical and Electronic Equipment in the Range of 9kHz to 40 GHz
Industry Canada ICES-003	Information Technology Equipment (ITE) – Limits and Methods of Measurement, Issue 5, Aug 2012
CAN/CSA-CEI/IEC CISPR22-02	Limits and methods of measurement of Radio Disturbance Characteristics of Information Technology Equipment



## DIMENSIONS

### IBYS DALI 160W

**HKM** · Hook Mounted

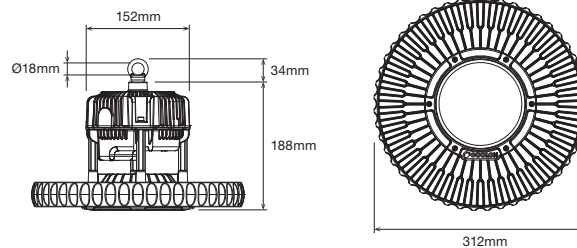

### IBYS DALI 240W

**HKM** · Hook Mounted

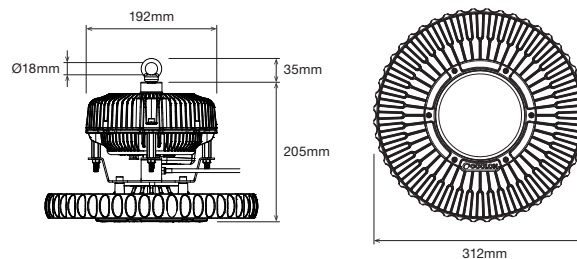

### IBYS DALI 160W

**WMBT** · Wall Mounted Bracket

+/-50° Rotation

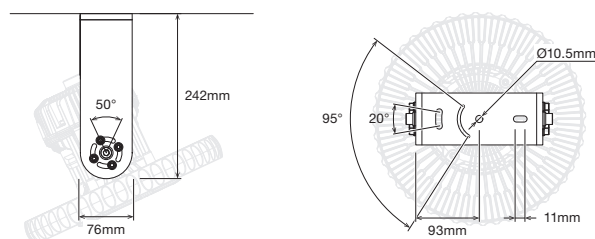

### IBYS DALI 240W

**WMB** · Wall Mounted Bracket

+/-60° Rotation

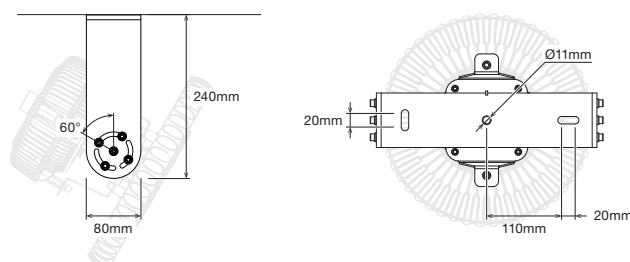

### IBYS DALI 160W

**CAN** · Suspended Can

+/-25° Rotation

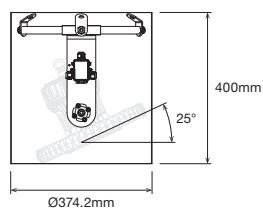

### IBYS DALI 160W

**CANR** · Suspended Recessed Can

+/-25° Rotation

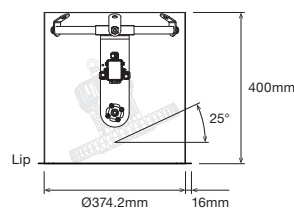

### IBYS DALI 160W

**CANSR** · Suspended Semi-Recessed Can

+/-25° Rotation

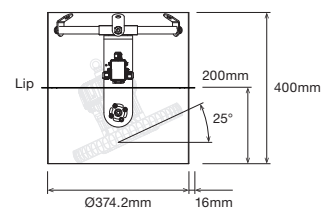

## IP RATING

**IP65**

Fully protected against dust. Protected  
against water jets from all directions

## ■ POLAR DISTRIBUTION

### OPTIC

### BEAM ANGLE

### POLAR DISTRIBUTION

NOP

120° Beam

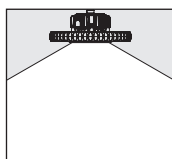

	160	240
3m	598	871
4m	329.8	480
6m	143.8	209
8m	80.1	116
10m	51	74
12m	35.3	51
E <sub>C</sub> at Centre (Lux)		

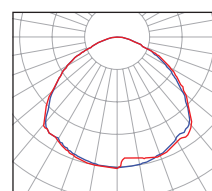

DM1

Dome Diffuser 1

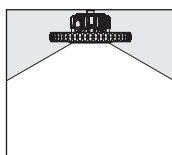

	160	240
3m	315	442
4m	173	243
6m	75	106
8m	42	59
10m	26	37
12m	18	26
E <sub>C</sub> at Centre (Lux)		

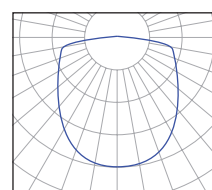

L65

65° Beam

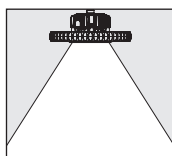

	160	240
3m	2782	3754
4m	1534	2070
6m	668.7	902
8m	372.5	502
10m	237	319
12m	164	221
E <sub>C</sub> at Centre (Lux)		

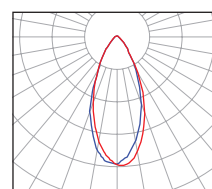

L30

30° Beam

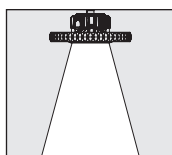

	160	240
3m	4562	6866
4m	2516	3787
6m	1097	1650
8m	610	919
10m	388	585
12m	268	404
E <sub>C</sub> at Centre (Lux)		

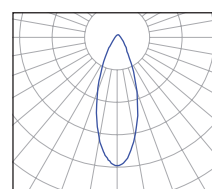

L15

15° Beam

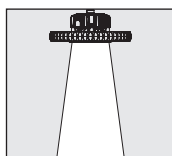

	160	240
3m	9420	20356
4m	5195	11227
6m	2136	4893
8m	1190	2726
10m	757	1735
12m	523	1200
E <sub>C</sub> at Centre (Lux)		

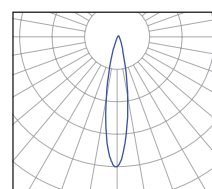

O4418

Oval 44° x 18° Beam

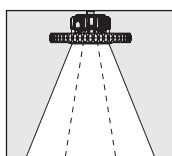

	160	240
3m	8887	11826
4m	4901	6522
6m	2136	2843
8m	1190	1584
10m	757	1008
12m	523	697
E <sub>C</sub> at Centre (Lux)		

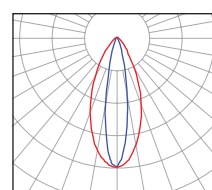

## ORDERING EXAMPLE

### HBY - IBYS DALI - 160 - 2.7K - L65 - BLK - HKM

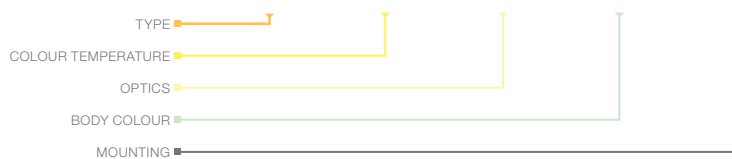

#### ■ TYPE PAGE 04

160	160W
240	240W

#### ■ COLOUR TEMPERATURE PAGE 04

2.7K	2700K CRI 80
2.7KCRI	2700K CRI 90
3.0K	3000K CRI 80
3.0KCRI	3000K CRI 90
4.0K	4000K CRI 80
5.0K	5000K CRI 80

#### ■ OPTICS PAGE 06

NOP	No Optics
DM1	Dome Diffuser
L65	65° Beam Angle
L30	30° Beam Angle
L15	15° Beam Angle
O4418	44 x 18 Oval Beam

#### ■ BODY COLOUR \*

BLK	Black
WHT	White
CST	Custom

#### ■ MOUNTING PAGE 05

HKM	Hook Mounted (Standard) for IBYS DALI 160W and 240W
WMB	Wall Mounted Bracket for IBYS DALI 240W
WMBT	Wall Mounted Bracket for IBYS DALI 160W
CAN	Suspended Can for IBYS DALI 160W
CANR	Suspended Recessed Can for IBYS DALI 160W
CANSR	Suspended Semi-Recessed Can for IBYS DALI 160W

\* PSU colour is always black