

**IECEX TRA 15.0001X Ex tb IIIC T65°C Db**

**CONDITION OF USE:** The equipment may be operated in an ambient temperature range of -20°C to 50°C.



**WARNING:**

Do not open any covers or optics. Factory sealed – no user serviceable parts inside. Potential electrostatic charging hazard – see cleaning instructions below.

**Mounting Plate**

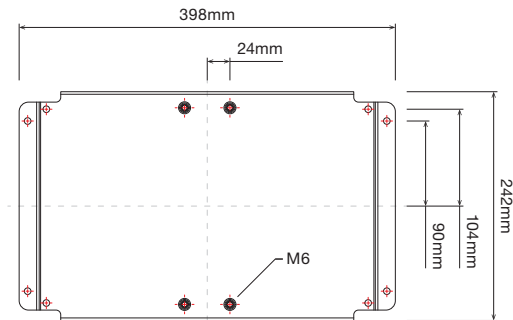

**CLEANING INSTRUCTIONS**

In order to ensure safe light levels are maintained during operation the optical face of the luminaire should be cleaned at regular intervals. The optical covers are made from polycarbonate.

- Use lukewarm soapy water and a soft sponge or cloth to clean the optical surface. If luminaires are not accessible by hand use a long-poled car or RV washing pad.
- If using soapy water rinse using clean water.
- After final rinse dry off with a soft cloth. Polycarbonate is vulnerable to scratching.
- Do not scrub with brushes, abrasive materials or sharp instruments as these will mark the surface.
- Never use solvents, alkaline cleaners, thinners or abrasive cleaners.
- Never steam clean, use low pressure if pressure washing.
- Never use: acetone, petrol, benzene, or solvents containing Butyl Cellosolve or Isopropanol.
- Incorrect cleaning which in any way damages the unit automatically renders void all warranties.

**INSTALLATION INSTRUCTIONS**

**Step 1**

Choose luminaire position and orientation.

When choosing the location of Tunnel Ray luminaire, please ensure that sufficient clearance is allowed for the airflow through the heatsink. Avoid blocking the air vents.

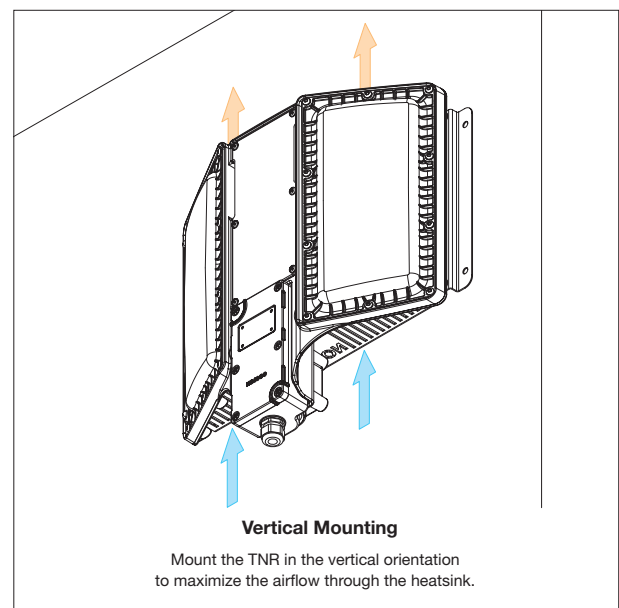
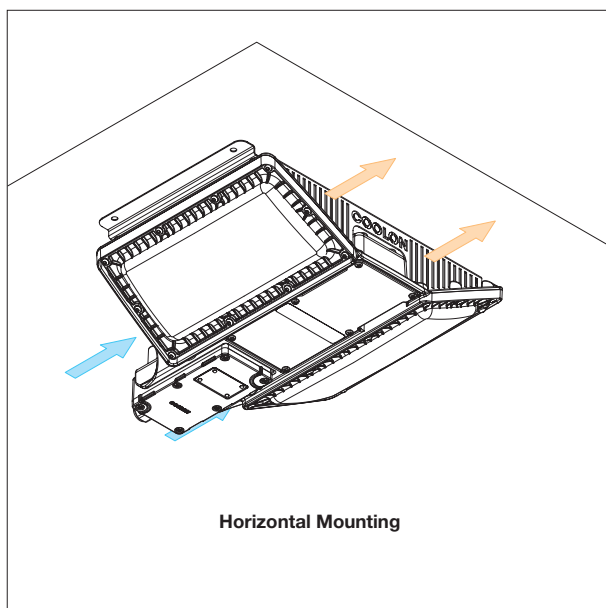

## INSTALLATION INSTRUCTIONS (Continued)

### Step 2

Once the Tunnel Ray is securely mounted, open the junction box. Ensure to only open an accessible area of the junction box that is sealed with Phillips Head screws.

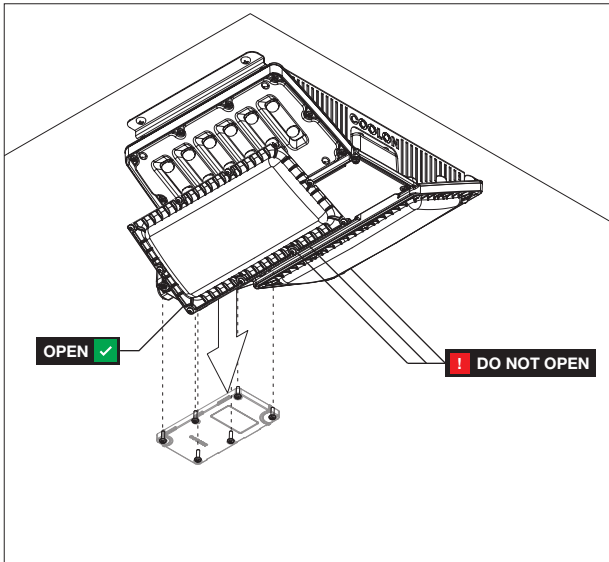

### Step 3

Feed the cable through the cable gland. Connect wires to terminals according to the wiring diagram below and secure the cable with the cable restrainer.

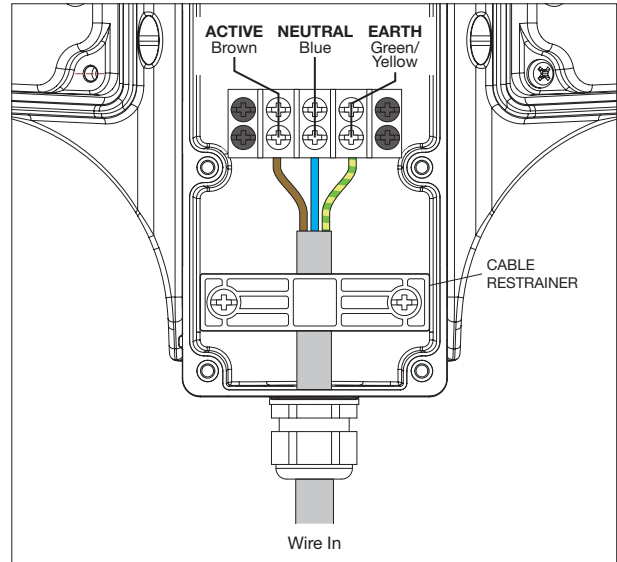

### Step 4

Close the junction box. Ensure the rubber gasket is intact and sits snugly in the dedicated channel. Secure junction box cover back onto the Tunnel Ray luminaire using the Phillips Head screws.

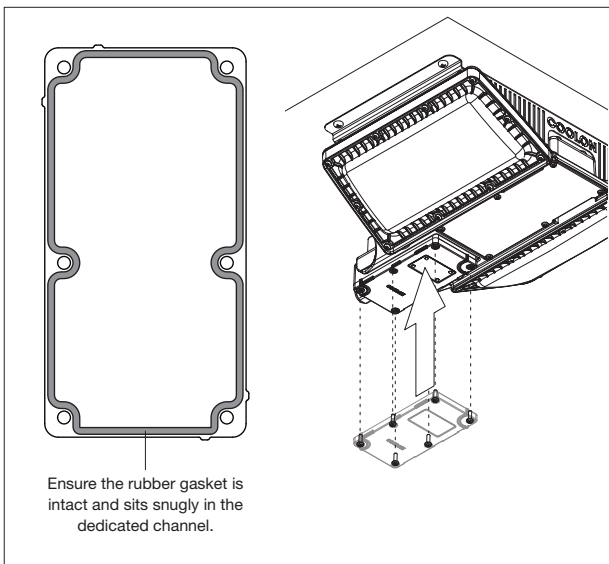

### External Earthing

When mounted on a non-conductive or non-earthed facilities, the body of the luminaire needs to be externally grounded.

One of the 4, M6 nutserts can be used as appropriate. It is recommended that a spring/locking washer and 4mm<sup>2</sup> cable with a suitable terminal is used (not supplied with the fitting).

