



MAX MINI INSTALLATION INSTRUCTIONS



▪ PROFILE DIMENSIONS

Wire from side

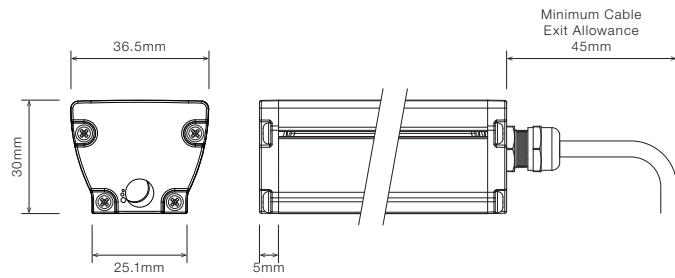

Wire from back

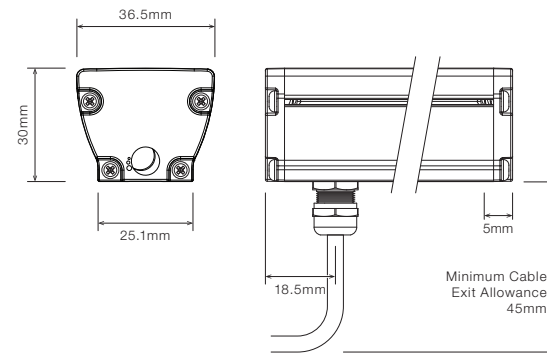

Cable Gland

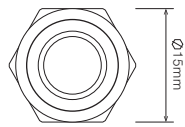

⚠ ATTENTION

- Please observe / follow the instructions methodically.
- Please ensure the units are handled with extreme care.
- Do not remove LED strips from packaging prematurely. Only remove from packaging when ready for installation.
- Failure to observe installation instructions and handling will void warranty of the product.
- Fittings must be installed by a licensed electrician.
- Before installing, make sure the power supply is switched off.

▪ WIRING OPTIONS

2 wires (RB) - Indoor only

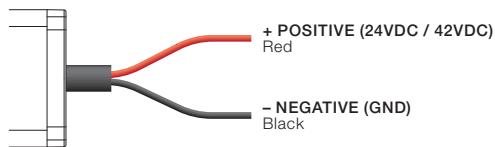

2.2pin Male connector - Outdoor only



3 wires (RBW) - Indoor only

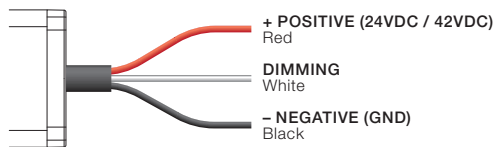

6pin Male connector - Outdoor only



■ PROFILE DIMENSIONS WITH C-CLIP

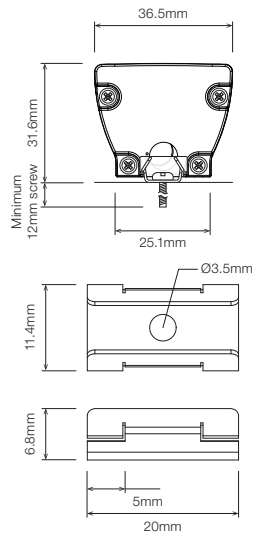

■ PROFILE DIMENSIONS WITH ROTATING BRACKET

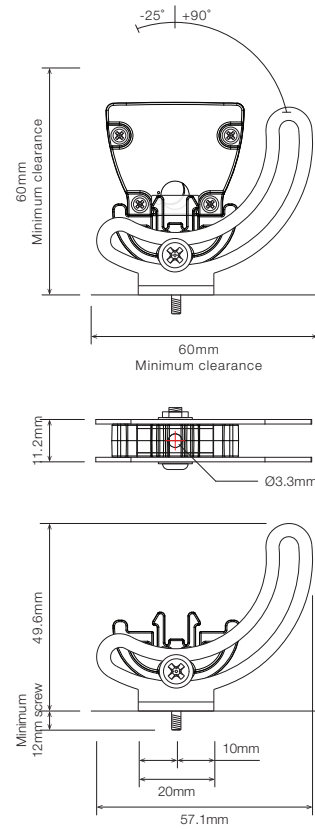

■ PROFILE DIMENSIONS WITH ELEVATED ROTATING BRACKET

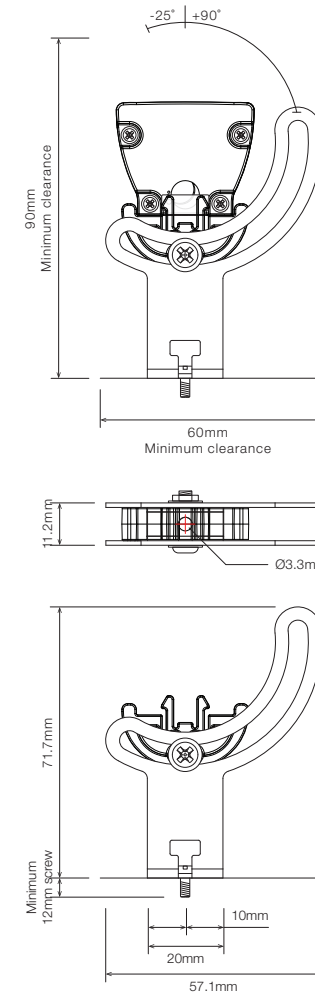

▪ STEP 1

Before you begin installation, ensure that you understand the fitting layout required as supplied fitting lengths may vary.

Refer to the supplied cut sheet for length breakdowns.

* For fittings 1 metre or longer two installers are recommended.

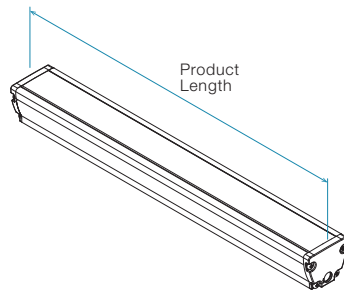

▪ WIRED FROM BACK ONLY

If the fitting is wired from the back it will need to be wired **before** mounting.

Ensure that you have allowed enough space to accommodate the cable gland exiting the back.

Wire the fitting to the correct power supply as advised on the cut sheet.

▪ WIRED FROM SIDE ONLY

If the fitting is wired from the side it will need to be wired **after** mounting.

Wire the fitting to the correct power supply as advised on the cut sheet.

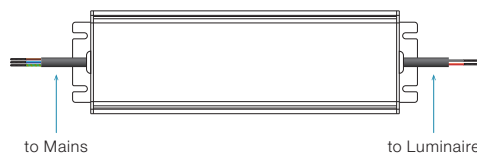

▪ MOUNTING C-CLIP

▪ STEP 1

Prepare mounting clips and screws (Ø3mm with a minimum length of 12mm). Secure mounting clips with screws on timber or metal surface ensuring that mounting clips are straight with spacings of 300mm.

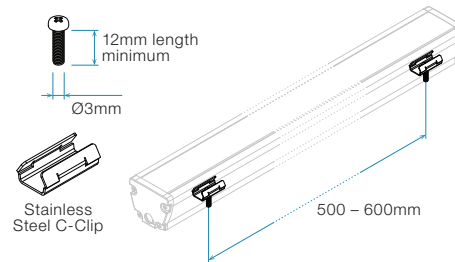

▪ STEP 2

Lay the LED fitting on top of the clips and align so all clips are centred. Starting at one end push down the fitting until you hear the clip lock into place. Continue along the profile until all clips are locked.

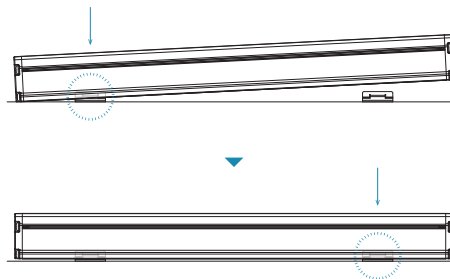

▪ ROTATING BRACKET

▪ STEP 1

Prepare mounting brackets and screws (Ø3mm with a minimum length of 12mm). Slide clip away from base so that you have clear access to screw holes.

Secure the base with screws on timber or metal surface ensuring that they are straight with spacings of 500 – 600mm. Slide mounting clip back to the base when you are done.

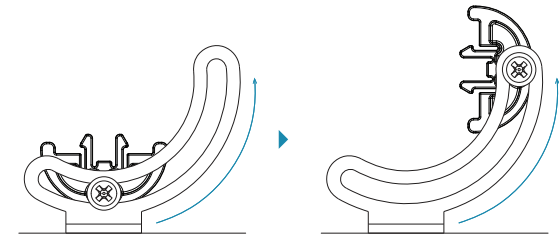

▪ STEP 2

Ensure that all brackets are rotated the same way with the locking clips parallel with the base. Starting at one end push down the fitting until you hear that the clip lock into place. Continue along the profile until all clips are locked.

Once fitting is fully connected you can rotate the fitting to your desired angle.

