

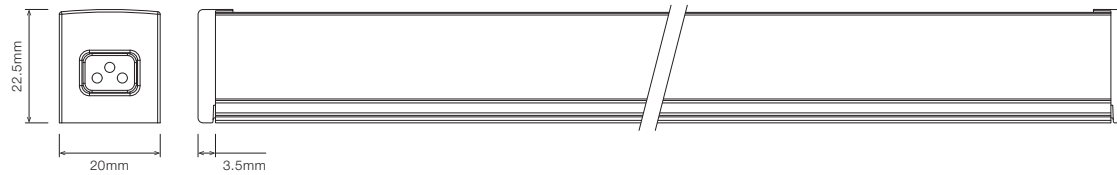

P20 STRIP PROFILE INSTALLATION INSTRUCTIONS



PROFILE DIMENSIONS



⚠ ATTENTION

- Please observe / follow the instructions methodically.
- Please ensure the units are handled with extreme care.
- Do not remove LED strips from packaging prematurely. Only remove from packaging when ready for installation.
- Failure to observe installation instructions and handling will void warranty of the product.

MOUNTING OPTIONS

With MC-CCLIP20 Stainless Steel C-Clip

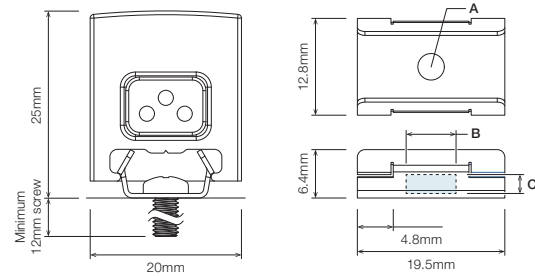

RECOMMENDED REBATE When using MC-CCLIP20 only

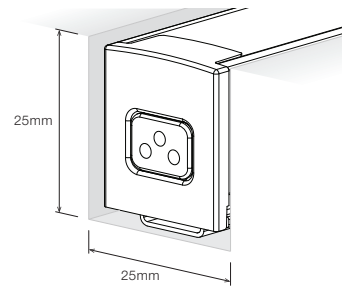

	MC-CCLIP20	MC-STR-P20R
A (Ø_mm) Screw outer diameter	3.3	4
B (Ø_mm) Screw head clearance	6.6	N/A
C (mm) Screw head pocket depth	2.5	N/A

With MBR-RB-TA-BLK & MBR-RB-TB-BLK Rotating Bracket Type A & Type B

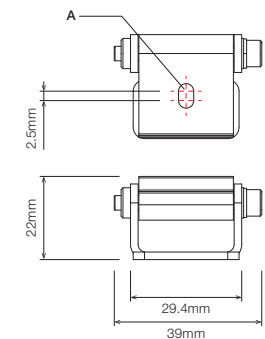
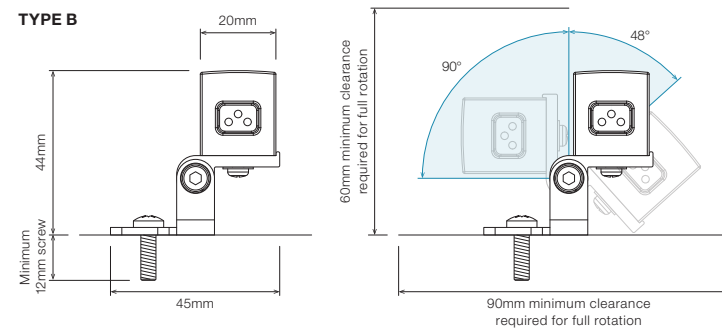
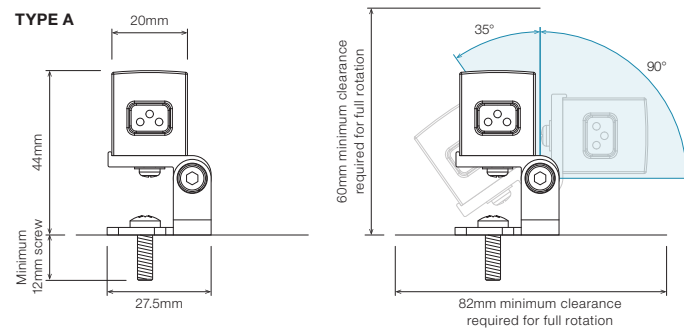



■ WIRING OPTIONS

2 Wires (RB) – Indoor only

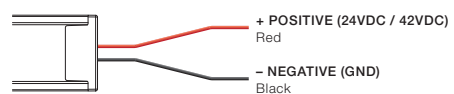

3 Wires (RWB) – Indoor only

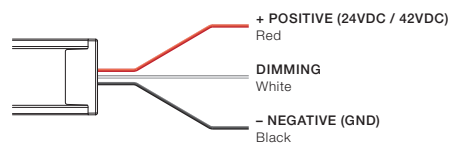

Connector 2 Pin (RB)



Connector 3 Pin (RWB)



Locking Connector 2 Pin



Round Cable 2 Wires (RB)

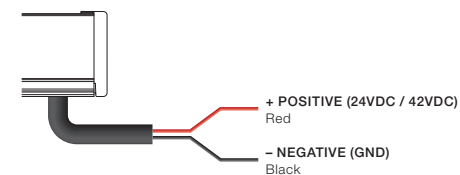

STEP 1

Before you begin installation, ensure that you understand the fitting layout required as supplied lengths may vary.

Refer to the supplied cut sheet for length breakdowns.

* For fittings 1m or longer two installers are recommended.

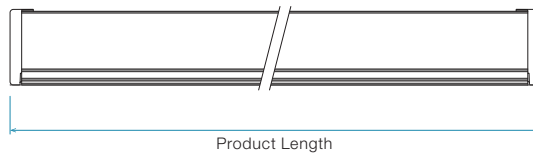

WIRING

If the fitting is wired from the back:

It will need to be wired before mounting.

If the fitting is wired from the side:

It will need to be wired after mounting.

Wire the fitting to the correct power supply as advised on the cut sheet.

STAINLESS STEEL C-CLIP

STEP 2

Prepare mounting clips and screws (Ø3.5mm).

Secure mounting clips with screws on timber or metal surface ensuring that mounting clips are positioned screw side up with spacings of 200 – 300mm.

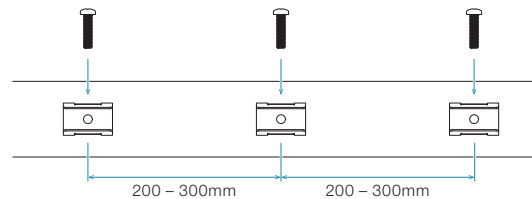

STEP 3

Lay the luminaire on top of the clips and align so all clips are centred. Starting at one end push down the fitting until you hear the clip lock into place. Continue along the profile until all clips are locked.

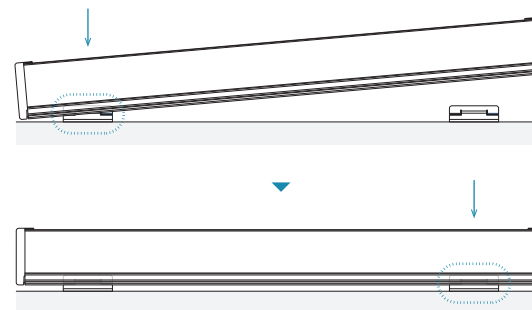

ROTATING BRACKET TYPE A & TYPE B

STEP 2

Place rhomb nut in the base of the extrusion of the luminaire, ensuring that the edges of the nut are parallel with the edges of the extrusion.

Next place the plastic aligning clip over the rhomb nut.

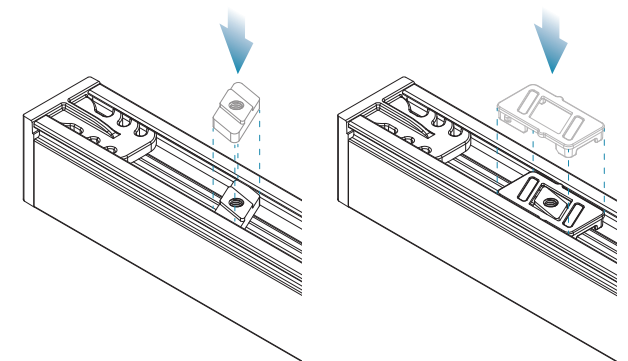

STEP 3

Place the edge of the bracket (with the slight lip) over the extrusion and secure the bracket to the rhomb nut using the screw provided.

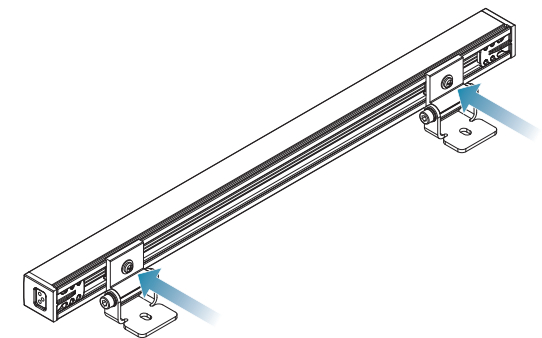

▪ STEP 4

Prepare screws (Ø4mm). Secure the other side of the bracket with screws on timber or metal surface ensuring that mounting clips are straight with spacings of 1,000mm.

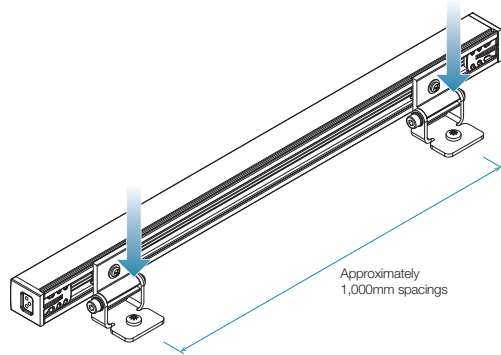

▪ STEP 5

Rotate the fitting to the desired angle and use Allen key provided to tighten bracket to secure in place.

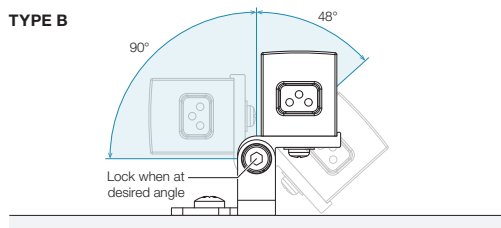
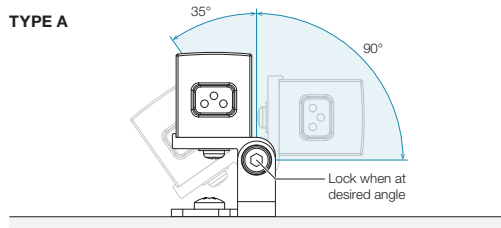

▪ STEP 6

Wire the fitting to the correct power supply as advised on the cut sheet.

* Typically supplied with AU flex and plug (1.8m long)

