



 COOLON

CP66

320W LED Flood Light

High performing flood light designed specifically for lighting towers

The high lumen output and narrow beam optics of the CP66 allows a single tower to illuminate extremely large areas. The power supply unit can be positioned separately for easy maintenance.

Designed for use in:

- Lighting Towers
- Area Lighting
- Flood Lighting



Guaranteed performance & robust design

Robust design allows lighting towers to be safely transported over long distances on Australia's rough, corrugated, outback roads. The CP66 is reliably sealed against damaging water and ingress of dust, guaranteeing performance.

Built to last

Unlike conventional LED floodlights, the CP66 was designed to withstand constant abuse.

- Resistant to Vibration, Impact & Shock Proof
- Chemical Resistant
- High Pressure Washable
- Unaffected by Severe Temperature Variations



COOL SURFACE TEMPERATURE

Coolon's Industrial LED fittings have a much lower surface temperature than traditional HID equivalents which prevents dirt from baking onto the luminaire. This allows for easier cleaning and will prolong the lifespan of the luminaire.



INSTANT ON/OFF

LEDs do not require warm up. Instant on to 100% output translates to no downtime, improved safety and the ability to utilize sensor switching to significantly save energy.



NO FLICKERING

LED luminaires run on constant low voltage DC power and do not produce any visible stroboscopic effects, thus reducing the strain on eyes and significantly improving safety in areas where moving machinery is present.

IP66

HIGH IP RATING - IP66

Coolon's Industrial LEDs are designed specifically to withstand the harsh conditions in mining environments. The robust design allows our LED products to be used in many different applications and are high pressure washable.



UNRESTRICTED BURNING POSITION

Coolon's LED luminaires can be positioned and oriented in any desired way without affecting the lifespan of the product. This gives greater flexibility when it comes to aiming angles and orientation.



EXTRA LOW VOLTAGE OPERATION

Our products operate on extra low voltage DC power. It is substantially safer to work with than conventional mains powered light sources.

5
YEARS

5 YEARS FACTORY WARRANTY

Coolon luminaires are covered by a solid comprehensive manufacturer's warranty that covers a range of possible defects and performance parameters throughout the duration of the warranty period.



PROUDLY MADE IN AUSTRALIA

Engineered to perfection, using only the highest quality components and highly skilled labour, each luminaire is assembled and thoroughly tested to ensure that it exceeds the highest standards.

DIMENSIONS

CP66 Luminaire

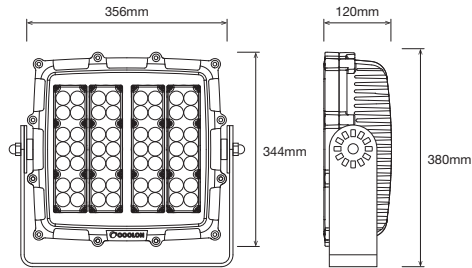

Fixed Plant Bracket (FPB)

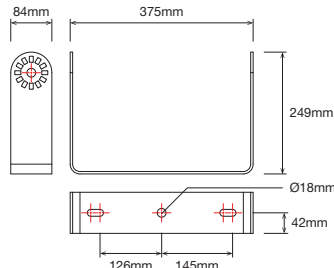

Mobile Plant Bracket (MPB)

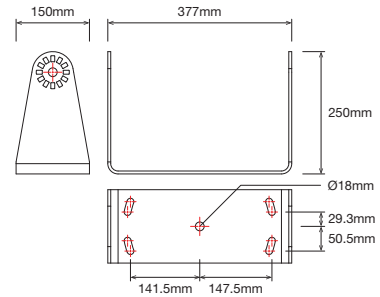

POWER SUPPLY DIMENSIONS

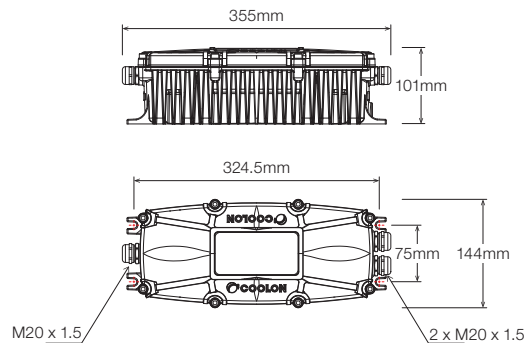

MOBILE LIGHTING APPLICATION

The CP66 can be powered by a DC generator, provided the power is supplied via a 48VDC battery.

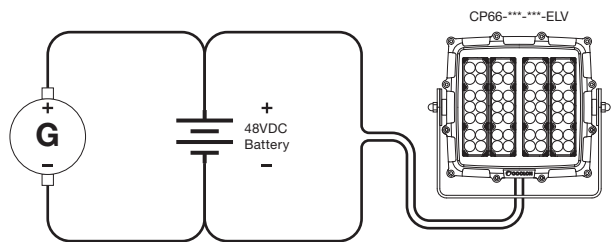

COLOUR TEMPERATURES



All colour temperatures are indicative. Some variation can occur.

TECHNICAL SPECIFICATIONS

Product	CP66 LED Flood Light
Model	CP66

Optical Characteristics

Luminous Flux (Photometered)	30,766 – 36,783 lm
CCT	CWT / NWT / WWT
CRI	>70

Electrical Characteristics

Power Consumption	320W
Voltage In	45 - 48VDC
Cable Type	UL2095, 16 AWG x 2C Braid PVC, UV Resistant
Cable Diameter	7.5mm
Luminaire Cable Length	2m

Electrical Characteristics (Power Supply 0281AL)

Model Part Number	PWR-CLN-320-48-0281AL
Voltage Range	100 – 277VAC / 140 – 350VDC
Frequency Range	47 – 63Hz
Power Factor	>0.95 / 230VAC
Leakage Current	<0.75mA / 277VAC

Inrush and Leakage Currents ^{2 3 4}

Peak Inrush Current (A) @230V	11.5
Duration - twtdth (ms)	2.4
I ² t (A ² S)	0.36
Leakage Current (mA)	<0.75mA @ 230V / 60Hz

Maximum number of luminaires per MCB @ 230V

B16	5
C16	7
D16	8

Environmental

IP Rating	IP66
Impact Rating	IK09
Salt Spray Tested	Yes
Operating Temp. Range	-20 to +50°C
Thermal Management Type	Active/Continuous
Expected Lifespan	50,000 Hours to 70% Brightness
Material Composition (Body)	LM6 Aluminium Alloy (<0.1% copper content)
Material Composition (Optics)	PMMA
Material Composition (Bracket)	Heavy Duty Steel
Material Composition (Cover)	Tempered Glass
Mounting/Bracket Type	FPB (Standard) MPB (Optional)
Angle Adjustment	+/- 90° in 30° Steps

Weight/Packaging (CP66)

	FPB	MPB + Plate	SSFPB
Luminaire Weight	12kg		
Bracket Weight	3kg	8.5kg	3.1kg
Packaging Dimensions	W 460mm H 440mm D 180mm	W 460mm H 440mm D 360mm	W 460mm H 440mm D 180mm
Packaged Weight	16kg	22kg	16.1kg

Weight/Packaging (Power Supply)

Unit Weight	5kg
Packaging Dimensions	W 350mm H 155mm D 125mm
Packaged Weight	5.2kg

Warranty

Warranty	5 years warranty as standard
----------	------------------------------

¹ Optical and electrical characteristics are measured using Cool White LEDs (CWT)

² Note: At 230VAC input, 25°C cold start, 10%lpk-10%lpk.

³ Reading taken while test unit operating in steady state. Ambient temperature during testing is typically 25°C. Individual unit behaviour may differ due to electronic component tolerance and ambient conditions. Product parameters and application suitability shall be checked by the user prior to commissioning.

⁴ Number of luminaires is subject to relative MCB properties, assuming a 30mA leakage current limit and MCB steady state current load not exceeding 60%, 70% and 80% for the B, C, D type MCB respectively.

CP66 KIT CONFIGURATION

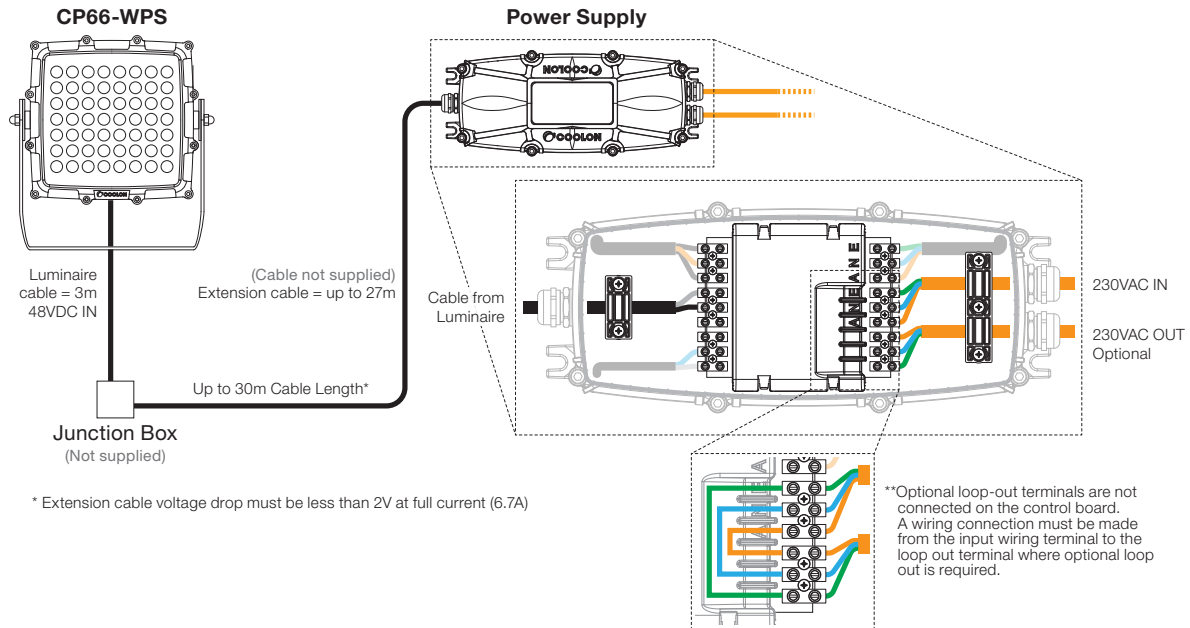

ILLUMINANCE AT DISTANCE

NOTE: Illuminance at distance are measured using Cool White LEDs (CWT)

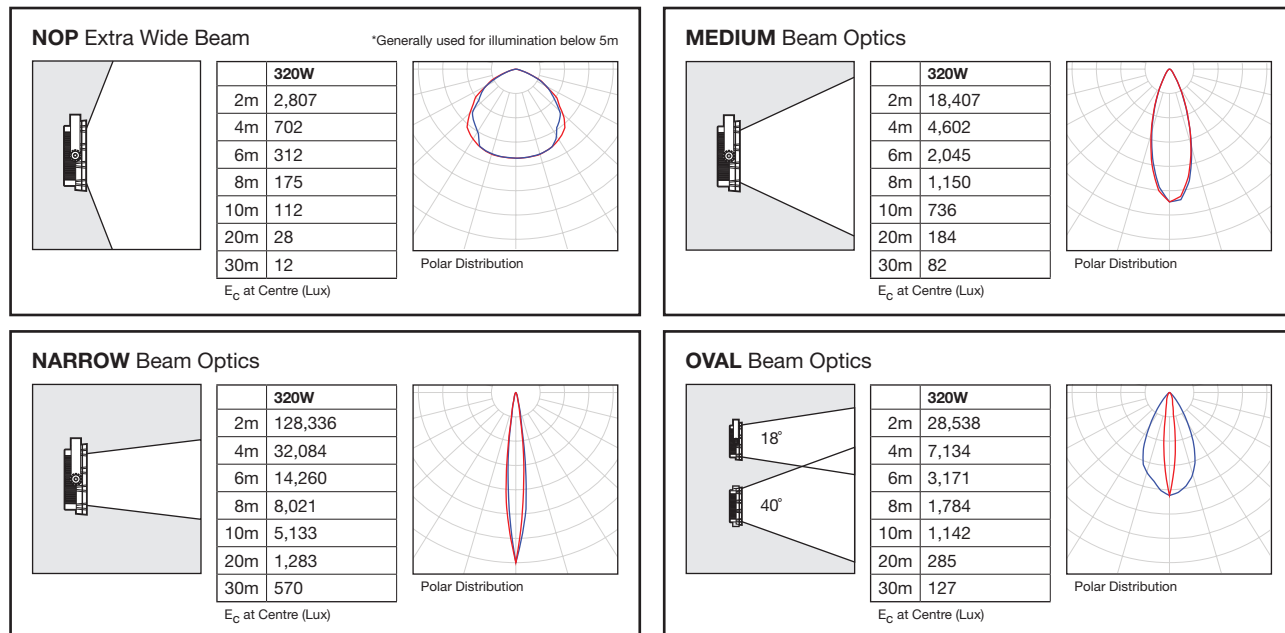

ORDERING EXAMPLE

CP66 - NWT¹ - NARROW - FPB² - WPS

PRODUCT COLOUR TEMPERATURE OPTICS MOUNTING SUPPLY OPTION

PRODUCT	COLOUR TEMPERATURE	OPTICS	MOUNTING	SUPPLY OPTION
CP66	CWT Cool White	NOP Extra Wide Beam	FPB Fixed Plant Bracket	WPS with Power Supply
	NWT Neutral White	MEDIUM Medium Beam	MPB Mobile Plant Bracket	
	WWT Warm White	NARROW Narrow Beam	SSFPB Stainless Steel Fixed Plant Bracket	
		OVAL Oval Beam		

¹ If COLOUR TEMPERATURE is not specified, Neutral White LEDs (NWT) will be supplied

² If MOUNTING is not specified, Fixed Plant Bracket (FPB) will be supplied

KIT DESCRIPTION

KIT	PART #	DESCRIPTION
WPS	CP66-***-***-ELV	CP66 Luminaire, 320W, Extra Low Voltage
	PWR-CLN-320-48-0281AL	Coolon Industrial Power Supply 320W IP66, 48V constant voltage, 230VAC nominal input voltage in 281 Aluminium Enclosure