

CP14-UG Luminaire with Standard Bracket

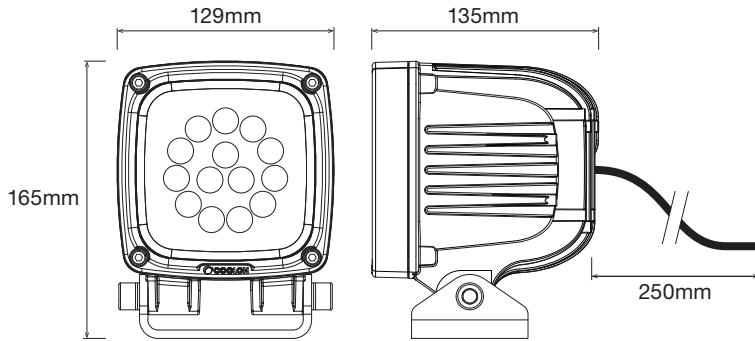

Optional Clip-on Cover
ACC-CP14-COVER (available separately)

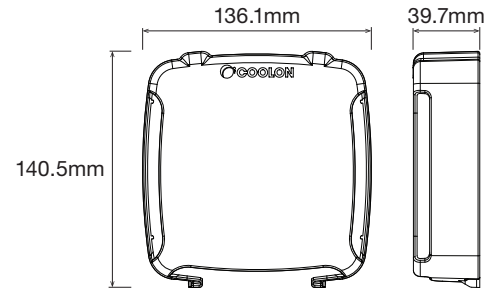

INSTALLATION INSTRUCTIONS

Step 1

Adjust the mounting angle and secure the CP14-UG lamp to the mounting bracket using the Norlock Washers and M10 hex screws.

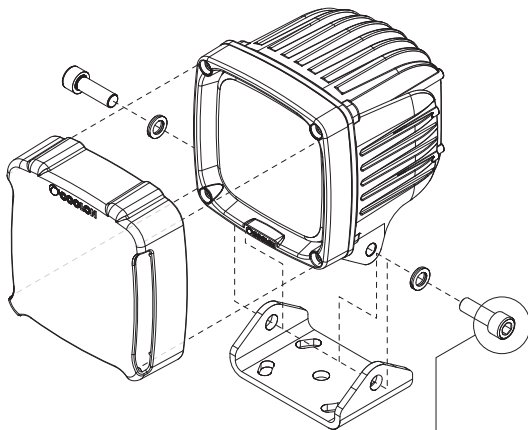

Recommended Torque 37 Nm
Max Torque 48 Nm

Step 2

Connect to compatible power supply according to wiring diagram below.

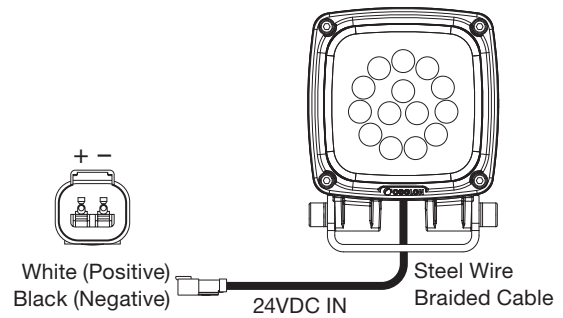

Visit the following link or scan the QR code for a quick demonstration showing the removal and installation of the clip-on cover: goo.gl/OZvYjc

⚠ ATTENTION:
Unit must not be operated with the clip-on cover and optical face blocked or obstructed.

The clip-on cover and other optical surfaces are to be kept clean for optimal light output and to prevent damage to the integral optics and cover.

Replace the clip-on cover if it is damaged or cannot be cleaned. Damage to the fitting due to operation with an obstructed optical face will not be covered by warranty.