

CP12 Luminaire with Standard Bracket

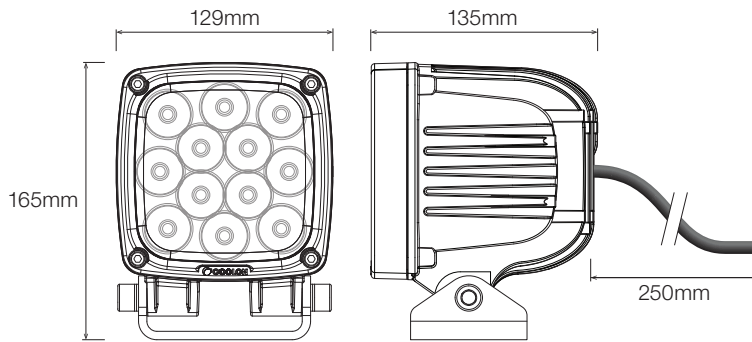

Optional Clip-on Cover

ACC-CP12-COVER (available separately)

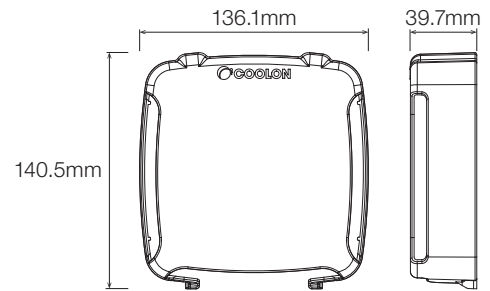

MODEL	VOLTAGE IN	POWER	OPERATING TEMP.	IP RATING	IK RATING
CP12-48	21 – 34VDC	48W @ 24VDC	$-20^{\circ}\text{C} \leq T_{\text{amb}} \leq 50^{\circ}\text{C}$	IP66	IK07
CP12-60	21 – 34VDC	60W @ 24VDC	$-20^{\circ}\text{C} \leq T_{\text{amb}} \leq 50^{\circ}\text{C}$	IP66	IK07

INSTALLATION INSTRUCTIONS

Step 1

Adjust the mounting angle and secure the CP12 lamp to the mounting bracket using the Norlock Washers and M10 hex screws.

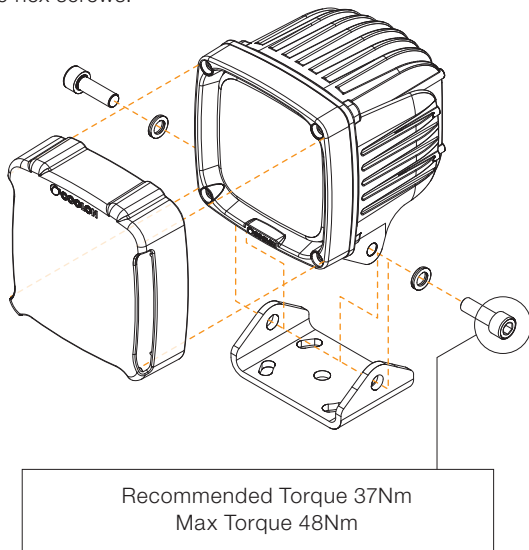

Recommended Torque 37Nm
Max Torque 48Nm



Visit the following link or scan the QR code for a quick demonstration showing the removal and installation of the clip-on cover: goo.gl/OZvYjc

WIRING

CP12-ELV

Deutsch DT04-2P Connector

(Fits DT06-2S)

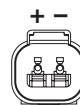

White (Positive)
Black (Negative)

24VDC IN

Steel Wire Braided Cable

CP12-DIM

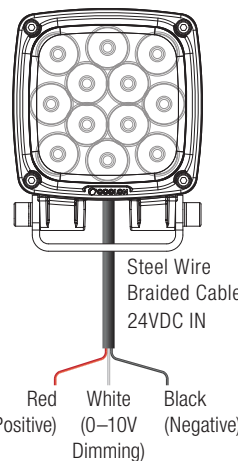

CP12-DIM-DT04-4P

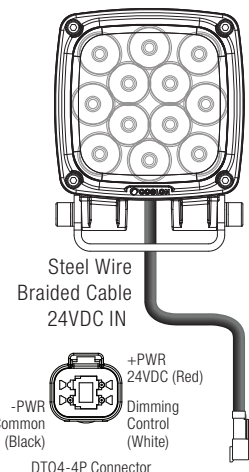

ATTENTION

Unit must not be operated with the clip-on cover and optical face blocked or obstructed.

The clip-on cover and other optical surfaces are to be kept clean for optimal light output and to prevent damage to the integral optics and cover.

Replace the clip-on cover if it is damaged or cannot be cleaned. Damage to the fitting due to operation with an obstructed optical face will not be covered by warranty.

