

# ALTO

LED STRIP STR-ALTO

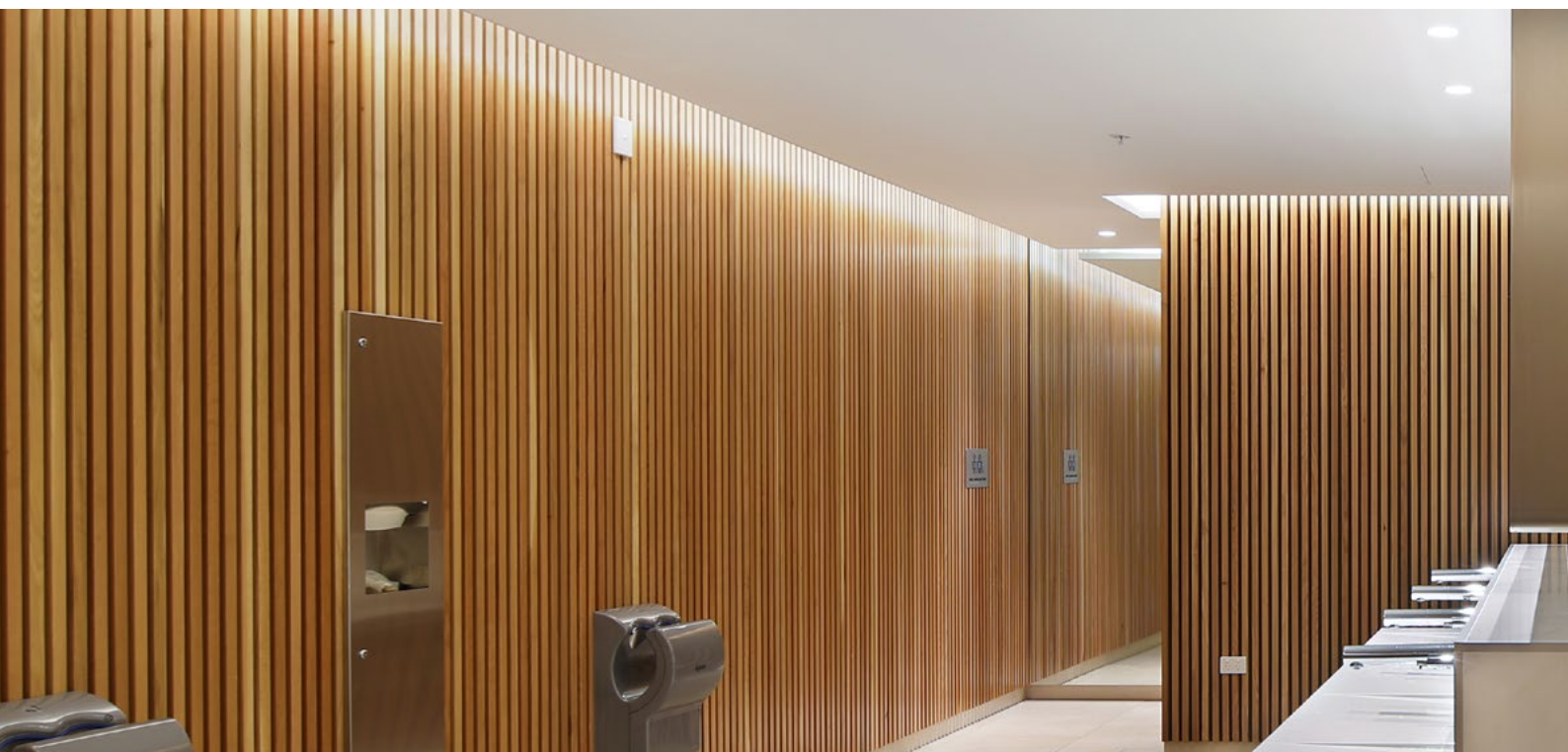

## POWER

## PROFILE / LUMINOUS FLUX



		SD	RD	P17D	PR17D
<b>11W</b>	11.2W / metre	1,060 lm / metre	1,190 lm / metre	1,010 lm / metre	1,010 lm / metre
<b>16W</b>	16.8W / metre	1,590 lm / metre	1,820 lm / metre	1,540 lm / metre	1,540 lm / metre
<b>33W</b>	33.6W / metre	-	-	2,800 lm / metre	2,800 lm / metre

## COLOUR TEMPERATURE

2700K

3000K

4000K

## DIMENSIONS

**SD** • Standard Profile

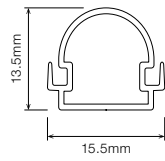

**RD** • Reinforced Profile

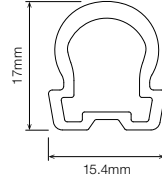

**P17D** • P17 Profile

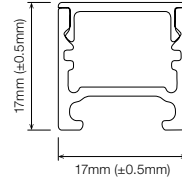

**PR17D** • P17 Recessed Profile

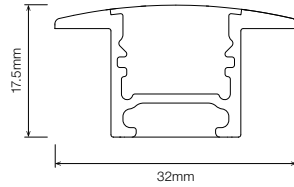

## ORDERING EXAMPLE

STR-ALTO	16W	3.0K	S2A0	P17D	WHT	WR2BS	100	IP40												
TYPE	WATTAGE	CCT	SEGMENTS	PROFILE / DIFFUSER	PROFILE COLOUR	WIRING CONFIG.	WIRING LENGTH	IP RATING												
<p>■ <b>WATTAGE</b></p> <table border="1"> <tr> <td>11W</td> <td>11.2W per Metre</td> </tr> <tr> <td>16W</td> <td>16.8W per Metre</td> </tr> </table>									11W	11.2W per Metre	16W	16.8W per Metre								
11W	11.2W per Metre																			
16W	16.8W per Metre																			
<p>■ <b>PROFILE COLOUR</b><sup>2</sup></p> <table border="1"> <tr> <td>WHT</td> <td>White (Standard)</td> </tr> <tr> <td>BLK</td> <td>Black</td> </tr> <tr> <td>CST</td> <td>Custom Colour</td> </tr> </table>									WHT	White (Standard)	BLK	Black	CST	Custom Colour						
WHT	White (Standard)																			
BLK	Black																			
CST	Custom Colour																			
<p>■ <b>COLOUR TEMPERATURE</b><sup>1</sup></p> <table border="1"> <tr> <td>2.7K</td> <td>2700K CRI 80</td> </tr> <tr> <td>2.7KCRI</td> <td>2700K CRI 90</td> </tr> <tr> <td>3.0K</td> <td>3000K CRI 80</td> </tr> <tr> <td>3.0KCRI</td> <td>3000K CRI 90</td> </tr> <tr> <td>4.0K</td> <td>4000K CRI 80</td> </tr> <tr> <td>4.0KCRI</td> <td>4000K CRI 90</td> </tr> </table>									2.7K	2700K CRI 80	2.7KCRI	2700K CRI 90	3.0K	3000K CRI 80	3.0KCRI	3000K CRI 90	4.0K	4000K CRI 80	4.0KCRI	4000K CRI 90
2.7K	2700K CRI 80																			
2.7KCRI	2700K CRI 90																			
3.0K	3000K CRI 80																			
3.0KCRI	3000K CRI 90																			
4.0K	4000K CRI 80																			
4.0KCRI	4000K CRI 90																			
<p>■ <b>WIRING CONFIGURATION</b></p> <table border="1"> <tr> <td>WR2OS</td> <td>Wire 2 Core One Side</td> </tr> <tr> <td>WR2BS</td> <td>Wire 2 Core Both Sides</td> </tr> <tr> <td>OC2MO</td> <td>Outdoor Connector 2 pin Male Only</td> </tr> <tr> <td>OC2MF</td> <td>Outdoor Connector 2 pin Male + Female</td> </tr> <tr> <td>SMPLC</td> <td>Sample Type Connector 2.5mm</td> </tr> </table>									WR2OS	Wire 2 Core One Side	WR2BS	Wire 2 Core Both Sides	OC2MO	Outdoor Connector 2 pin Male Only	OC2MF	Outdoor Connector 2 pin Male + Female	SMPLC	Sample Type Connector 2.5mm		
WR2OS	Wire 2 Core One Side																			
WR2BS	Wire 2 Core Both Sides																			
OC2MO	Outdoor Connector 2 pin Male Only																			
OC2MF	Outdoor Connector 2 pin Male + Female																			
SMPLC	Sample Type Connector 2.5mm																			
<p>■ <b>PRODUCT LENGTH</b></p> <table border="1"> <tr> <td colspan="2">Length as per Site Measurements</td> </tr> <tr> <td colspan="2">Length:</td> </tr> <tr> <td colspan="2">Undefined</td> </tr> </table>									Length as per Site Measurements		Length:		Undefined							
Length as per Site Measurements																				
Length:																				
Undefined																				
<p>■ <b>WIRING LENGTH</b></p> <table border="1"> <tr> <td>100</td> <td>100mm</td> </tr> <tr> <td>250</td> <td>250mm</td> </tr> <tr> <td>500</td> <td>500mm</td> </tr> <tr> <td>1000</td> <td>1,000mm</td> </tr> </table>									100	100mm	250	250mm	500	500mm	1000	1,000mm				
100	100mm																			
250	250mm																			
500	500mm																			
1000	1,000mm																			
<p>■ <b>PROFILE / DIFFUSER</b></p> <table border="1"> <tr> <td>SD</td> <td>Standard Profile Diffused</td> </tr> <tr> <td>RD</td> <td>Reinforced Profile Diffused</td> </tr> <tr> <td>P17D</td> <td>P17 Profile Diffused</td> </tr> <tr> <td>PR17D</td> <td>P17 Recessed Profile Diffused</td> </tr> </table>									SD	Standard Profile Diffused	RD	Reinforced Profile Diffused	P17D	P17 Profile Diffused	PR17D	P17 Recessed Profile Diffused				
SD	Standard Profile Diffused																			
RD	Reinforced Profile Diffused																			
P17D	P17 Profile Diffused																			
PR17D	P17 Recessed Profile Diffused																			
<p>■ <b>IP RATING</b></p> <table border="1"> <tr> <td>IP40</td> <td>Indoor Use</td> </tr> </table>									IP40	Indoor Use										
IP40	Indoor Use																			

<sup>1</sup> Other CCT subject to availability.

<sup>2</sup> Profile colour applicable to P17 and PR17 only. Custom colours available on request.