

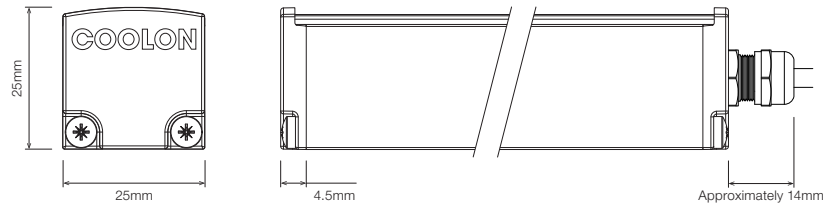

ARIS INSTALLATION INSTRUCTIONS



▪ PROFILE DIMENSIONS



⚠ ATTENTION

- Please observe / follow the instructions methodically.
- Please ensure the units are handled with extreme care.
- Do not remove LED strips from packaging prematurely. Only remove from packaging when ready for installation.
- Failure to observe installation instructions and handling will void warranty of the product.

▪ DIMENSIONS WITH STAINLESS STEEL C-CLIP

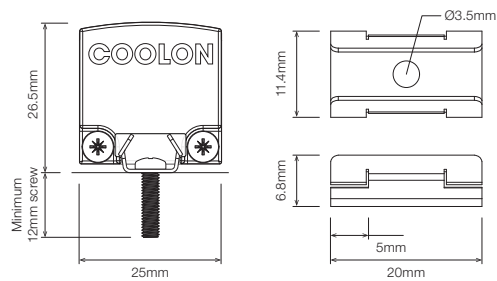

▪ DIMENSIONS WITH ROTATING MOUNTING BRACKET

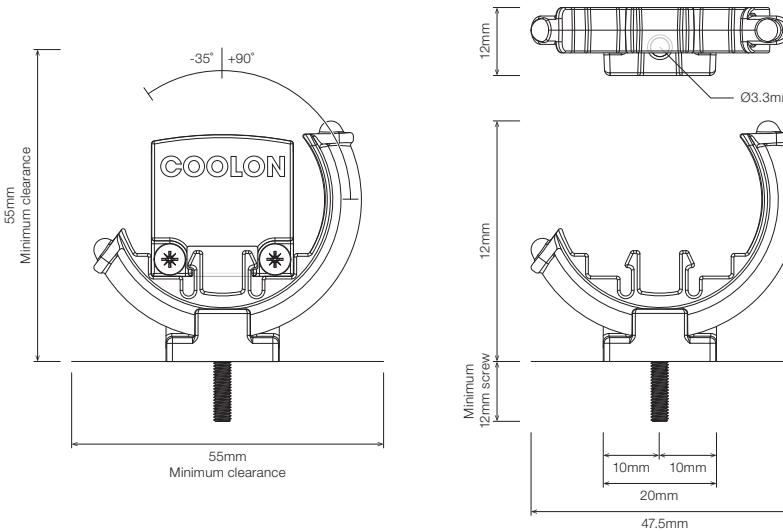

▪ WIRING OPTIONS

3 wires (RBW)

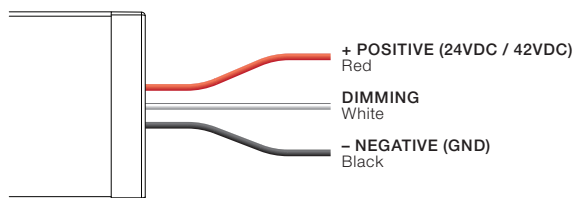

▪ STEP 1

Before you begin installation, ensure that you understand the fitting layout required as supplied fitting lengths may vary.

Refer to the supplied cut sheet for length breakdowns.

* For fittings 1 metre or longer two installers are recommended.

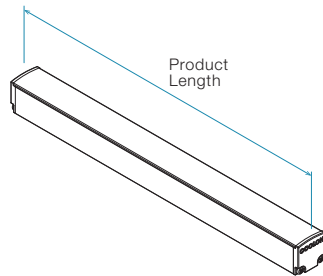

▪ WIRING

If the fitting is wired from the back:

It will need to be wired *before* mounting.

If the fitting is wired from the side:

It will need to be wired *after* mounting.

Wire the fitting to the correct power supply as advised on the cut sheet.

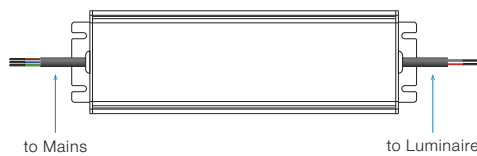

AC/L (Brown)
AC/N (Blue)
FGⓄ (Green/Yellow)

-V (Black)
+V (Red)

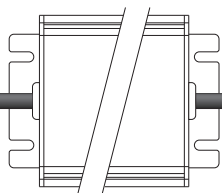

STAINLESS STEEL C-CLIP

▪ STEP 3

Prepare mounting clips and screws (Ø3mm with a minimum length of 12mm). Secure mounting clips with screws on timber or metal surface ensuring that mounting clips are straight with spacings of 500 – 600mm.

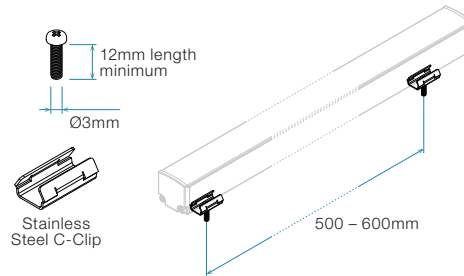

▪ STEP 4

Lay the LED fitting on top of the clips and align so all clips are centred. Starting at one end push down the fitting until you hear the clip lock into place. Continue along the profile until all clips are locked.

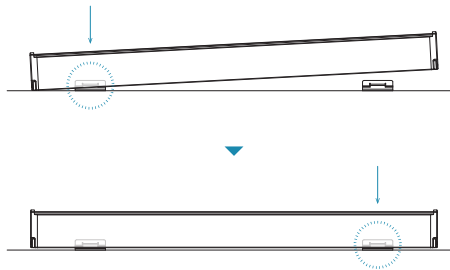

ROTATING MOUNTING BRACKET

▪ STEP 3

Prepare mounting brackets and screws (Ø3mm with a minimum length of 12mm). Separate the bracket into two parts: rotating mechanism and base.

Secure the base with screws on timber or metal surface ensuring that they are straight with spacings of 500 – 600mm. Push the rotating mechanism into the secured base to connect them again.

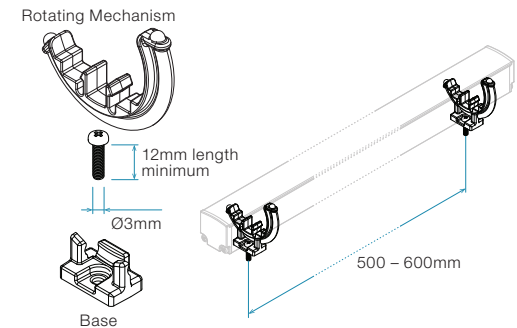

▪ STEP 4

Ensure that all brackets are rotated the same way with the locking clips parallel with the base. Starting at one end push down the fitting until you hear that the clip lock into place. Continue along the profile until all clips are locked.

Once fitting is fully connected you can rotate the fitting to your desired angle.

