

## RETROLED INDUSTRIAL LED LUMINAIRE Installation Instructions



Wherever possible, we aim to use recyclable packaging product. Please help us to care for the environment by disposing of all recyclable materials appropriately.

# RETROLED Technical Specifications

## Luminaire

Luminous Flux	3500 - 5500 lm
Power Consumption (including power supply)	80W Max
Power Supply	24VDC 100W
Inrush Current	Cold Start 40A/230VAC
Current Consumption	0.45A/230VAC
IP Rating	IP66
Power Factor	>0.95
Weight	6.5kg
Body	Aluminium Alloy (Powder Coated)

## Light Module

LED Efficacy	Up to 90lm/w @ 25°C
Max. Operating Voltage	26V
Min. Operating Voltage	23V
Body	Aluminium Alloy* (Marine Grade Black Anodized)

\*Composition available on request

Package Dimensions	568x225x160mm
Package Weight	7.2kg

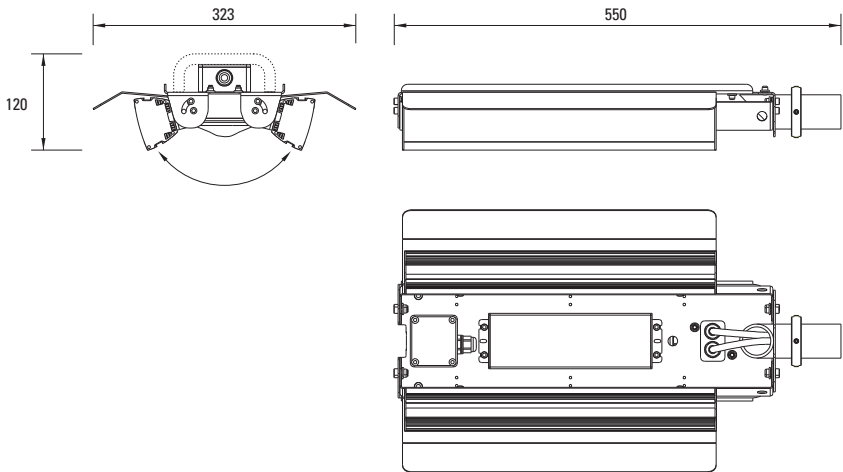

# Installation Instructions

**Step 1** Slide the RetroLED onto the spigot until reaches the stopper bolt.

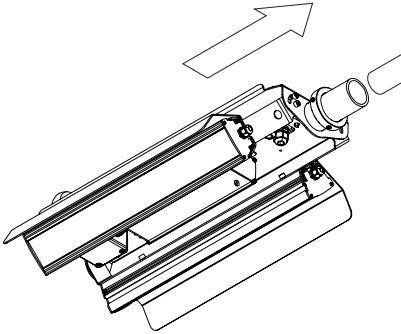

**Step 2** Open up the top junction box.

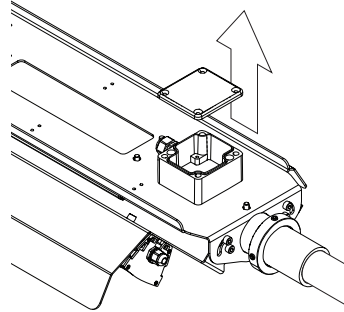

**Step 3** Feed the wires from the spigot through the cable glands and wire the connections.

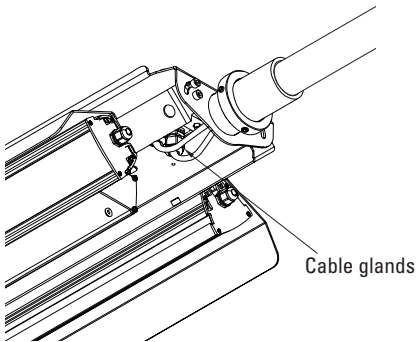

**Step 4** Close and secure the junction box and then tighten the cable glands.

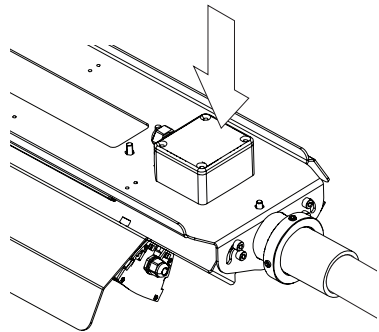

**Step 5** Tighten the nuts on the mounting bracket to secure the luminaire to the spigot.

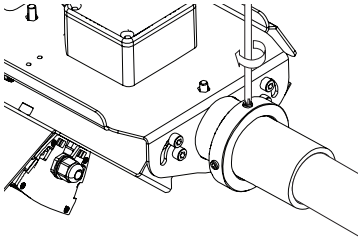

**Step 6** Unscrew nut and adjust the angle of the fitting and screw the nut to secure in position.

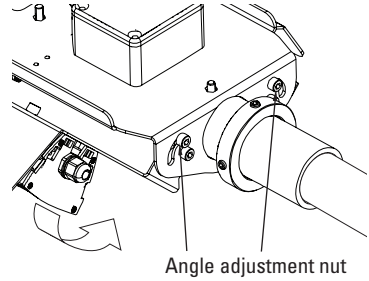

In high vibration areas, please use Loctite® 243™ retaining compound (not included) to secure.

## WARNING

Do not open this junction box. This junction box is factory sealed. Opening it will void the warranty.

