

# **STATIC** **RETROLED**

INDUSTRIAL LED LUMINAIRE

## Installation Instructions



Wherever possible, we aim to use recyclable packaging product. Please help us to care for the environment by disposing of all recyclable materials appropriately.

## STATIC RETROLED Technical Specifications

### Luminaire

Luminous Flux	3500 - 5500 lm
Power Consumption (including power supply)	50.2W Typical, 56.6W Start
Power Supply (Built In)	Mean Well 24VDC 100W
Current Consumption	0.251A/240VAC
Operating Voltage Range	90-295VAC, 127-417VDC
Frequency Range	47-63Hz
Leakage Current	<0.75mA/240VAC
IP Rating	IP66
Power Factor	>0.83
Weight	6.9kg
Body	Stainless Steel

### Light Module

Max. Operating Voltage	26V
Min. Operating Voltage	23V
Body	Aluminium Alloy* (Marine Grade Black Anodised)

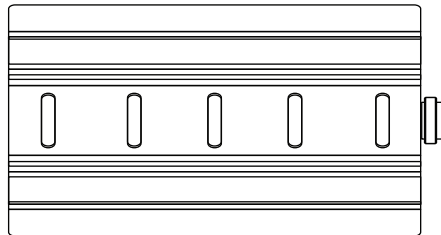
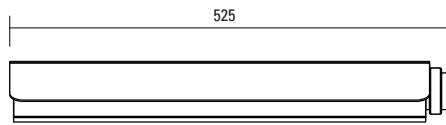
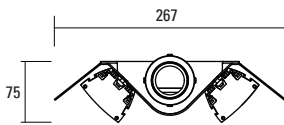

## Installation Instructions

- Step 1 Feed the cable through and slide the Static RetroLED onto the spigot
- 

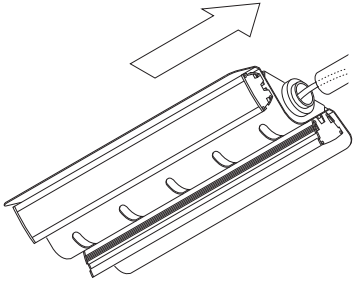

- Step 2 Tighten bolts to secure luminaire to the spigot
- 

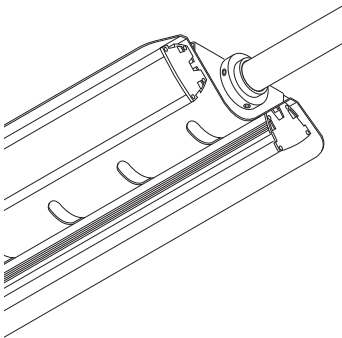



**phone:** +613 8681 3633    **fax:** +613 9703 2408  
**email:** [support@coolon.com.au](mailto:support@coolon.com.au)    **web:** [www.coolon.com.au](http://www.coolon.com.au)