

Luminaire Dimensions

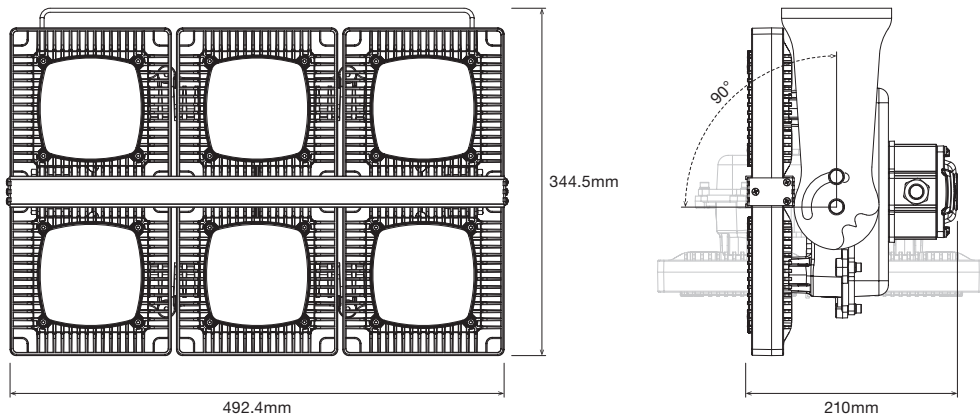

INSTALLATION INSTRUCTIONS

Step 1

Mount the NightHawk using 3 bolts (not supplied by Coolon). Please refer to the drawing below for sizing and spacing.

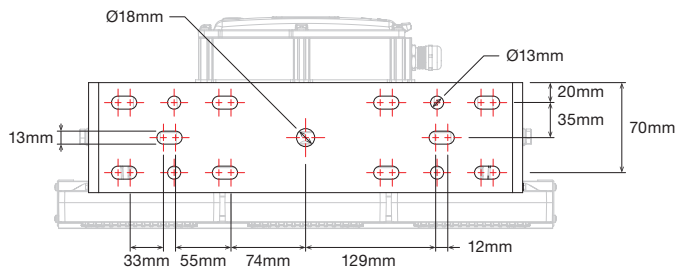

Step 2

Unscrew the 6 socket head cap screws and lift the junction box lid to gain access.

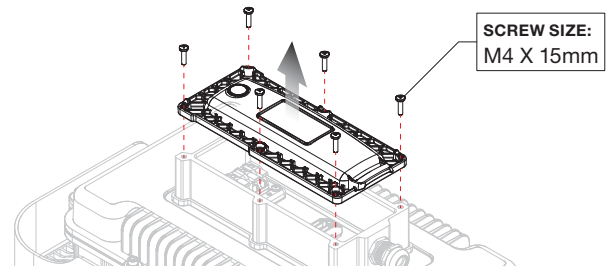

Step 3

NHL-MP

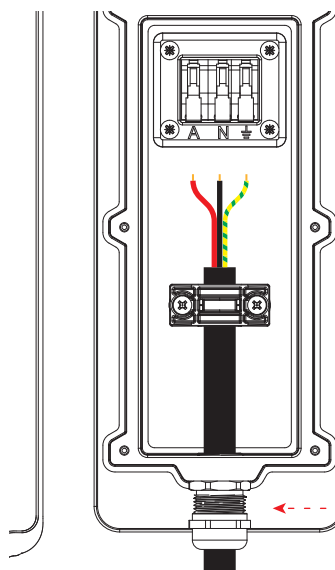

Proceed to connect wires as required. You can secure the cable using the plastic clamp.

Once connection is complete, fit the junction box back onto the fitting (reverse step 2).

Conductor Requirements

Conductor Size	0.5 – 6mm ²
AWG	20 – 10
Strip Length	11 – 12mm
Cable OD Min/Max	10mm/14mm

***NOTE:** Housing is earthed internally.



24mm wrench required for tightening the cable gland

NHL-LVL

