



MULTO HD

LED Strip





The Multo HD LED strip utilizes the latest and most efficient LEDs available today and is offered in a broad range of colour temperatures and colours.

Each LED segment (300mm) features 48 LEDs and can be divided in to 8 sub-segments of 37.5mm. Combined with thermal management, the Multo HD offers a completely uniform illuminated diffuser. The Multo HD is ideal for use in applications where a strip with larger LED pitch, may create an undesirable scalloping effects on the illuminated surface.

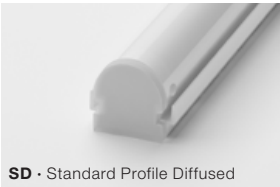

SD - Standard Profile Diffused



LD - Low Profile Diffused



P17D - P17 Profile Diffused

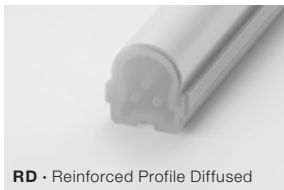

RD - Reinforced Profile Diffused

LUMINOUS FLUX

800 lm / metre

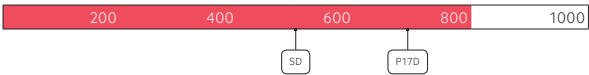

POWER

17W / metre



COLOUR TEMPERATURE

2700K – 5000K

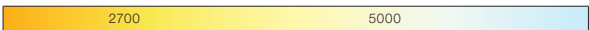

*Custom colours available on request



UNIFORM GLOW

Uniformly Glow denotes a uniformly illuminated diffuser. In most cases the diffuser height and pitch of the LED is closely observed to ensure uniformity along the diffuser.

INCREASED CRI

The Multo HD utilizes high CRI (90) Leds, boosting the colour and vibrancy of the illuminated object.

LOW CRI

HIGH CRI

L70

LONG USEFUL OPERATING LIFE

Currently available specification from world's most reputable LED manufacturers states 50,000 hours of continuous operation at the rated current within the operating temperature range to 70% residual light output.



VARIOUS CCT & COLOUR BINNING CONSISTENCY

Product is offered in various Colour Temperatures using tighter bins.

3
YEARS

3 YEARS FULL /SOLID WARRANTY

Coolon Luminaires are covered by a solid comprehensive manufacturer's warranty that covers a range of possible defects and performance parameters throughout the duration of the warranty period.



PROUDLY MADE IN AUSTRALIA

Our products are designed and manufactured in Australia. Engineered to perfection, using only the highest quality components and highly skilled labour, each luminaire is assembled and thoroughly tested to ensure that it exceeds the highest standards.

■ TECHNICAL SPECIFICATIONS

Product Code	STR-MULTO HD
Description	Multo HD Medium Power LED Strip
Segment Length (S)	300mm
Sub-Segment Length (A)	37.5mm
Number of Sub-Segments	8
Segment Width	10.50mm
LED Pitch	6.25mm
LEDs Per Segment	48
LEDs Per Sub Segment	6
Operating Voltage	24VDC
Typical Power Consumption per Segment	5.1W per 300mm Segment
Typical Power Consumption per Metre	17.0W per metre
Typical Current	213mA per 300mm Segment
Colour Rendering Index (CRI)	90+
Dimmable	With DALI / PWM
Effective Beam Angle	120°
External Heatsink Required	No
Ambient Operating Temp	Ta -40°C to 50°C
Thermal Operating	Yes (Active)
Average Lumen Maintenance @Ta 25°C	70% @ 50,000 Hours
IP Rating	IP40 (Standard)
Max Continuous Connection Length	Please refer to installation limitations

■ COLOUR BINNING

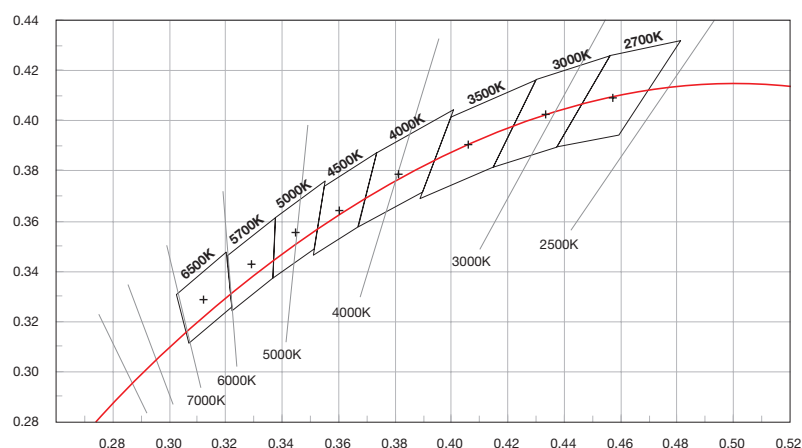

DIMENSIONS

For final strip lengths please refer to the "Product Length" table.

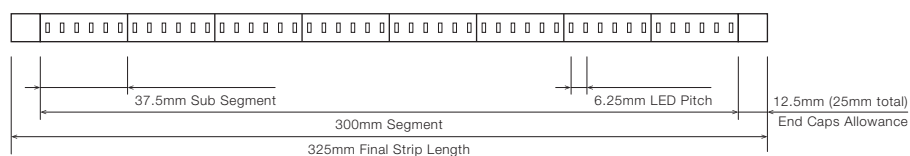

STANDARD PROFILE

Available in Clear and Diffused

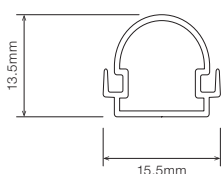

WITH MOUNTING CLIP

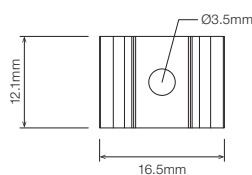
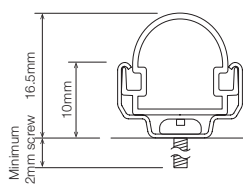

RECOMMENDED REBATE

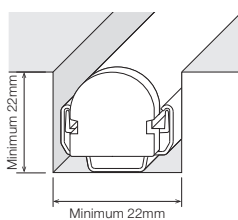

LOW PROFILE

Available in Clear and Diffused

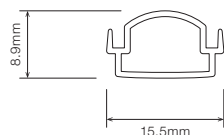

WITH MOUNTING CLIP

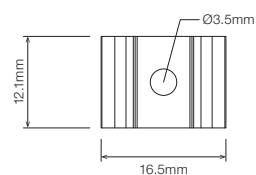
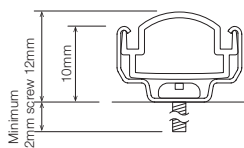

RECOMMENDED REBATE

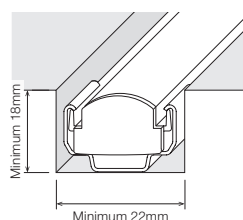

REINFORCED PROFILE

Available in Diffused

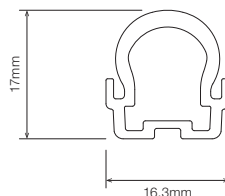

WITH MOUNTING CLIP

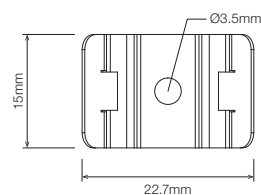
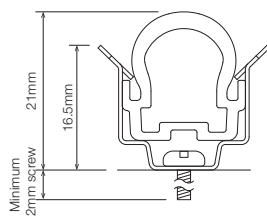

RECOMMENDED REBATE

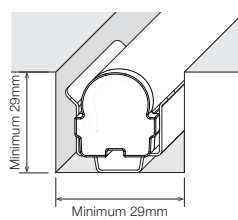

OPTIONAL MOUNTING WITH P30X20 PROFILE

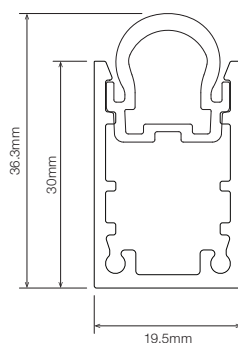

P17 PROFILE

Available in Clear and Diffused (IP40 only)

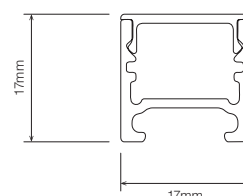

WITH MOUNTING X-CLIP

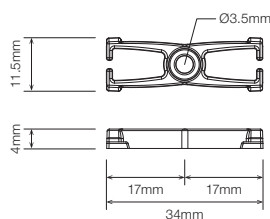
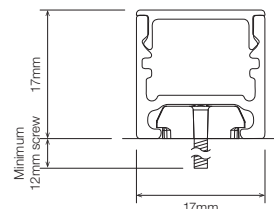

WITH ROTATING CLIP

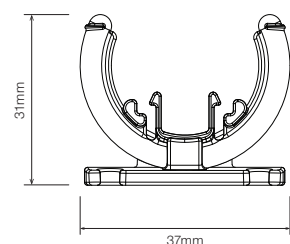
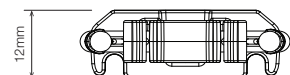
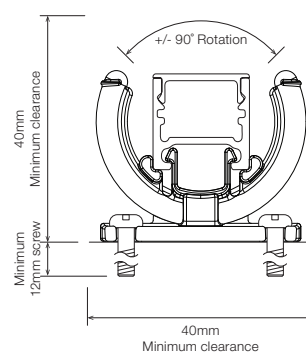

PRODUCT LENGTH

FULL SEGMENTS	SUB SEGMENTS	EXACT STRIP LENGTH	END CAP ALLOWANCE	FINAL LENGTH
0	1	37.5mm	add 25mm	62.5mm
0	2	75mm	add 25mm	100mm
0	3	112.5mm	add 25mm	137.5mm
0	4	150mm	add 25mm	175mm
0	5	187.5mm	add 25mm	212.5mm
0	6	225mm	add 25mm	250mm
0	7	262.5mm	add 25mm	287.5mm
1	0	300mm	add 25mm	325mm
1	1	337.5mm	add 25mm	362.5mm
1	2	375mm	add 25mm	400mm
1	3	412.5mm	add 25mm	437.5mm
1	4	450mm	add 25mm	475mm
1	5	487.5mm	add 25mm	512.5mm
1	6	525mm	add 25mm	550mm
1	7	562.5mm	add 25mm	587.5mm
2	0	600mm	add 25mm	625mm
2	1	637.5mm	add 25mm	662.5mm
2	2	675mm	add 25mm	700mm
2	3	712.5mm	add 25mm	737.5mm
2	4	750mm	add 25mm	775mm
2	5	787.5mm	add 25mm	812.5mm
2	6	825mm	add 25mm	850mm
2	7	862.5mm	add 25mm	887.5mm
3	0	900mm	add 25mm	925mm
3	1	937.5mm	add 25mm	962.5mm
3	2	975mm	add 25mm	1000mm
3	3	1012.5mm	add 25mm	1037.5mm
3	4	1050mm	add 25mm	1075mm
3	5	1087.5mm	add 25mm	1112.5mm
3	6	1125mm	add 25mm	1150mm
3	7	1162.5mm	add 25mm	1187.5mm
4	0	1200mm	add 25mm	1225mm
4	1	1237.5mm	add 25mm	1262.5mm
4	2	1275mm	add 25mm	1300mm
4	3	1312.5mm	add 25mm	1337.5mm
4	4	1350mm	add 25mm	1375mm
4	5	1387.5mm	add 25mm	1412.5mm
4	6	1425mm	add 25mm	1450mm
4	7	1462.5mm	add 25mm	1487.5mm
5	0	1500mm	add 25mm	1525mm

Continued on next page

⚠ WARNING

Do not bend LED strip when removing from mounting clips.

Gently twist LED Strip to remove from mounting clips.

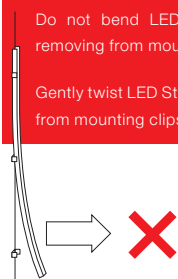

⚠ WARNING

PLEASE HANDLE LONG LED STRIPS WITH CARE.

LED Strips must not be bent.

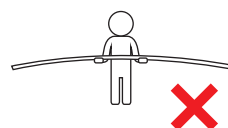

When handling LED Strips, please ensure that they are kept straight.

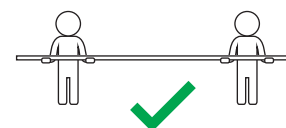

PRODUCT LENGTH

(CONTINUED)

FULL SEGMENTS	SUB SEGMENTS	EXACT STRIP LENGTH	END CAP ALLOWANCE	FINAL LENGTH
5	1	1537.5	add 25mm	1562.5mm
5	2	1575	add 25mm	1600mm
5	3	1612.5	add 25mm	1637.5mm
5	4	1650	add 25mm	1675mm
5	5	1687.5	add 25mm	1712.5mm
5	6	1725	add 25mm	1750mm
5	7	1762.5	add 25mm	1787.5mm
6	0	1800	add 25mm	1825mm
6	1	1837.5	add 25mm	1862.5mm
6	2	1875	add 25mm	1900mm
6	3	1912.5	add 25mm	1937.5mm
6	4	1950	add 25mm	1975mm
6	5	1987.5	add 25mm	2012.5mm
6	6	2025	add 25mm	2050mm
6	7	2062.5	add 25mm	2087.5mm
7	0	2100	add 25mm	2125mm
7	1	2137.5	add 25mm	2162.5mm
7	2	2175	add 25mm	2200mm
7	3	2212.5	add 25mm	2237.5mm
7	4	2250	add 25mm	2275mm
7	5	2287.5	add 25mm	2312.5mm
7	6	2325	add 25mm	2350mm
7	7	2362.5	add 25mm	2387.5mm
8	0	2400	add 25mm	2425mm
8	1	2437.5	add 25mm	2462.5mm
8	2	2475	add 25mm	2500mm
8	3	2512.5	add 25mm	2537.5mm
8	4	2550	add 25mm	2575mm
8	5	2587.5	add 25mm	2612.5mm
8	6	2625	add 25mm	2650mm
8	7	2662.5	add 25mm	2687.5mm
9	0	2700	add 25mm	2725mm
9	1	2737.5	add 25mm	2762.5mm
9	2	2775	add 25mm	2800mm
9	3	2812.5	add 25mm	2837.5mm
9	4	2850	add 25mm	2875mm
9	5	2887.5	add 25mm	2912.5mm
9	6	2925	add 25mm	2950mm
9	7	2962.5	add 25mm	2987.5mm

Confirm Interstate Courier Compliance

Custom Length subject to availability

⚠ WARNING

Do not bend LED strip when removing from mounting clips.

Gently twist LED Strip to remove from mounting clips.

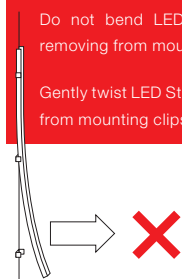

⚠ WARNING

PLEASE HANDLE LONG LED STRIPS WITH CARE.

LED Strips must not be bent.

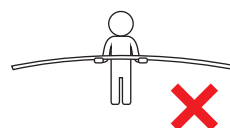

When handling LED Strips, please ensure that they are kept straight.

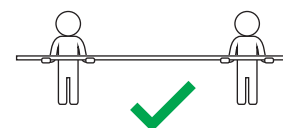

■ PROFILE /
DIFFUSER

SD • Standard Profile Diffused

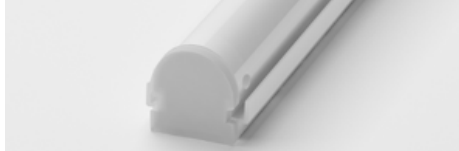

LD • Low Profile Diffused

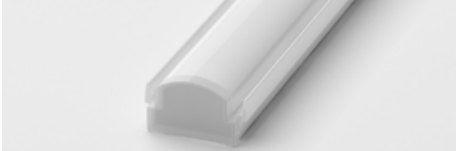

P17D • P17 Profile Diffused *



RD • Reinforced Profile Diffused

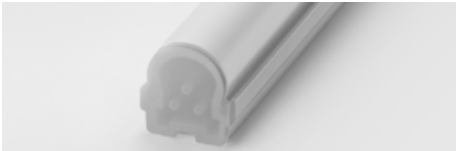

■ PROFILE
COLOUR

Profile colour applicable to P17 only.

BLK • Black (Standard)



WHT • White



CST • Custom Colour **



* P17 Profile available in IP40 only.

** Custom colours available on request.

■ WIRING
CONFIGURATION

CONNECTOR TYPE	DRAWING	FEMALE	MALE
WR2OS Wire 2 Core One Side			
WR2BS Wire 2 Core Both Sides			
WR4OS Wire 4 Core One Side			
WR4BS Wire 4 Core Both Sides			
OC2MO Outdoor Connector 2pin Male Only			
OC2FO Outdoor Connector 2pin Female Only			
OC2MF Outdoor Connector 2pin Male + Female			
OC4MO Outdoor Connector 4pin Male Only			
OC4FO Outdoor Connector 4pin Female Only			
OC4MF Outdoor Connector 4pin Male + Female			
SMPLC Sample Type Connector 2.5mm eee			

- Typical Loom Length 100 – 250mm.
- For detailed information on Outdoor IP67 connector please contact Coolon.
- Extension cables between LED fittings and driver or PSU is based on: LED load, outdoor or indoor applications.
Please consult Coolon for details.

WIRING COLOUR CODE	
Red	+ VDC
Black	GND

■ IP RATING

IP40 *

Protected against solid
objects greater than 1mm. No
protection against liquids.

IP65

Fully protected against dust.
Protected against water
jets from all directions

IP68

Fully protected against dust.
Protected against the effects of
prolonged immersion under water.

* P17 Profile available in IP40 only.

■ INSTALLATION LIMITS

SCENARIO 1

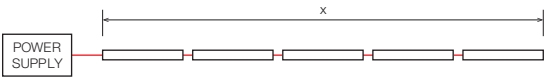

SCENARIO 2

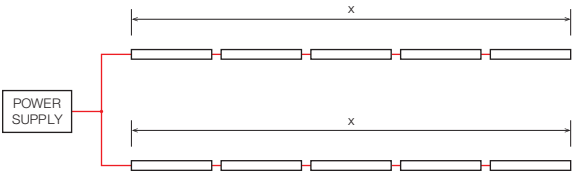

SCENARIO 3

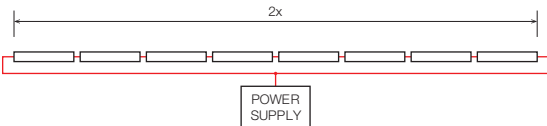

SCENARIO 4

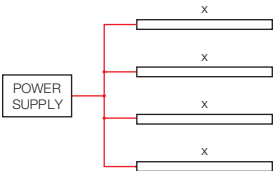

MAX. CONTINUOUS CONNECTION LENGTH (X)	CONNECTOR TYPE
8000 mm	With standard 2 core (WR2OS / WR2BS)
9200 mm	With upgraded 4 core (WR4OS / WR4BS)
3400 mm	With upgraded outdoor 2 pin connectors (OC2MO / OC2FO / OC2MF)
5800 mm	With upgraded outdoor 4 pin connectors (OC4MO / OC4FO / OC4MF)

- Extension cables between LED fittings and driver or PSU is based on: LED load, outdoor or indoor applications. Please consult Coolon for details.

⚠ WARNING

Avoid connecting multiple power supplies into a single circuit, unless they are specifically designed to do so.

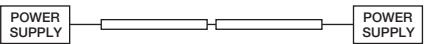
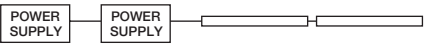

ORDERING EXAMPLE

STR - MULTO HD - 3.0K - S2A0 - P17D - BLK - WR2BS - IP40**

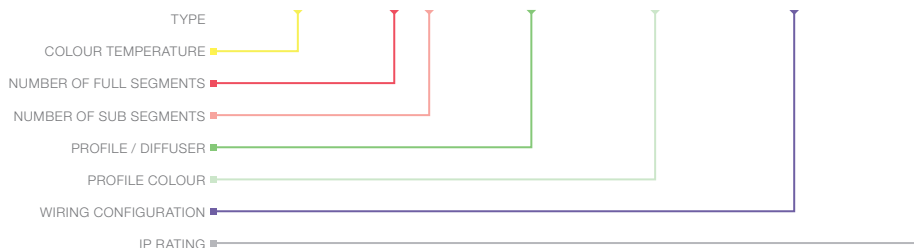

■ COLOUR TEMPERATURE * PAGE 04

2.7K	2700K
3.0K	3000K
4.0K	4000K
5.0K	5000K

■ PRODUCT LENGTH PAGE 06

FULL SEGMENTS	SUB SEGMENTS
S1	A0
S2	A1
S3	A2
S4	A3
S5	A4
S6	A5
S7	A6
S8	A7
S9	

■ PROFILE / DIFFUSER PAGE 08

SD	Standard Profile Diffused
LD	Low Profile Diffused
P17D	P17 Profile Diffused
RD	Reinforced Profile Diffused

■ PROFILE COLOUR ** PAGE 08

BLK	Black (Standard)
WHT	White
CST	Custom Colour

■ WIRING CONFIGURATION PAGE 09

WR2OS	Wire 2 Core One Side
WR2BS	Wire 2 Core Both Sides
WR4OS	Wire 4 Core One Side
WR4BS	Wire 4 Core Both Sides
OC2MO	Outdoor Connector 2 pin Male Only
OC2FO	Outdoor Connector 2 pin Female Only
OC2MF	Outdoor Connector 2 pin Male + Female
OC4MO	Outdoor Connector 4 pin Male Only
OC4FO	Outdoor Connector 4 pin Female Only
OC4MF	Outdoor Connector 4 pin Male + Female
SMPLC	Sample Type Connector 2.5mm

■ IP RATING *** PAGE 09





IP40
IP65
IP68

* Other CCT subject to availability.

** Profile colour applicable to P17 only. Custom colours available on request.

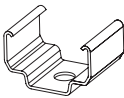
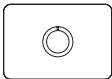
*** P17 Profile available in IP40 only.

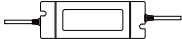
■ ACCESSORIES

	PRODUCT CODE	DESCRIPTION
MOUNTING CLIP		
	MC-1513	Stainless Steel Mounting Clips for Standard & Low Profile
	MC-RD	Stainless Steel Mounting Clips for Reinforced Profile
	MC-XCLIP	Flat Mount X-clip
	MC-P17R	Rotating Clip Mount for P17 Profile
CONTROLLER		
	CTR-PWM-10A	Coolon Wall Dimmer with 10A PWM Output
DRIVER		
	DRV-DALI-1X5A	Indoor DALI Point 1 channel Driver 5A
	DRV-DALI-IP1X10A	Outdoor DALI Point 1 channel Driver 10A
POWER SUPPLY FOR INDOOR USE		
	PWR-PLN20-24V	Mean Well Power Supply PLN 20W 24V IP64 + Flex & Plug
	PWR-PLN30-24V	Mean Well Power Supply PLN 30W 24V IP64 + Flex & Plug
	PWR-PLN60-24V	Mean Well Power Supply PLN 60W 24V IP64 + Flex & Plug
	PWR-PLN100-24V	Mean Well Power Supply PLN 100W 24V IP64 + Flex & Plug
POWER SUPPLY FOR OUTDOOR USE (IP67)		
	PWR-HLG40-24V	Mean Well Power Supply HLG 40W 24V IP67
	PWR-HLG60-24V	Mean Well Power Supply HLG 60W 24V IP67
	PWR-HLG100-24V	Mean Well Power Supply HLG 100W 24V IP67
	PWR-HLG150-24V	Mean Well Power Supply HLG 150W 24V IP67
	PWR-HLG185-24V	Mean Well Power Supply HLG 185W 24V IP67
	PWR-HLG240-24V	Mean Well Power Supply HLG 240W 24V IP67
	PWR-HLG320-24V	Mean Well Power Supply HLG 320W 24V IP67