



For driver view simulation, please visit
<http://www.coolon.com.au/cp9-sim>

 COOLON

CP9

48W/60W LED Flood Light

The CP9 sets the benchmark for heavy duty compact LED work light performance.

The Award Wining CP9 LED luminaire is designed for Mobile Plant machinery, such as haul-trucks, dozers and excavators.

Primarily the CP9 will be used on machines to provide forward facing and rearward illumination in quantities of 8 – 12 luminaires with varying optics and positioned to suit the size and function of the machine.

Designed specifically to size for a direct retrofit to most common factory fitted machine lights.

Designed for use in:

- Bulldozers
- Drill Rigs
- Excavators
- Flood Lights
- Graders
- Lighting Towers
- Processing Plants
- Trucks
- Warehouses



Direct retrofit

Same size, same shape and double the light. CP9 was specifically created to match the physical characteristics of most factory fitted halogen work lights.



Built to last

The CP9 is designed for the harshest environments and provides unrivaled reliability and performance, critical for demanding applications.

- Resistant to Vibration
- Impact / Shock Proof
- Chemical Resistant
- High Pressure Washable
- Unaffected by Severe Temperature Variations



COOL SURFACE TEMPERATURE

Coolon's Industrial LED fittings have a much lower surface temperature than traditional HID equivalents which prevents dirt from baking onto the luminaire. This allows for easier cleaning and will prolong the lifespan of the luminaire.



INSTANT ON/OFF

LEDs do not require warm up. Instant on to 100% output translates to no downtime, improved safety and the ability to utilize sensor switching to significantly save energy.



NO FLICKERING

LED luminaires run on constant low voltage DC power and do not produce any visible stroboscopic effects, thus reducing the strain on eyes and significantly improving safety in areas where moving machinery is present.

IP66

HIGH IP RATING - IP66

Coolon's Industrial LEDs are designed specifically to withstand the harsh conditions in mining environments. The robust design allows our LED products to be used in many different applications and are high pressure washable.



UNRESTRICTED BURNING POSITION

Coolon's LED luminaires can be positioned and oriented in any desired way without affecting the lifespan of the product. This gives greater flexibility when it comes to aiming angles and orientation.



EXTRA LOW VOLTAGE OPERATION

Our products operate on extra low voltage DC power. It is substantially safer to work with than conventional mains powered light sources.

3
YEARS

3 YEARS FACTORY WARRANTY

Coolon Luminaires are covered by a solid comprehensible manufacturer's warranty that covers a range of possible defects and performance parameters throughout the duration of the warranty period.



PROUDLY MADE IN AUSTRALIA

Engineered to perfection, using only the highest quality components and highly skilled labour, each luminaire is assembled and thoroughly tested to ensure that it exceeds the highest standards.

DIMENSIONS

CP9 Luminaire

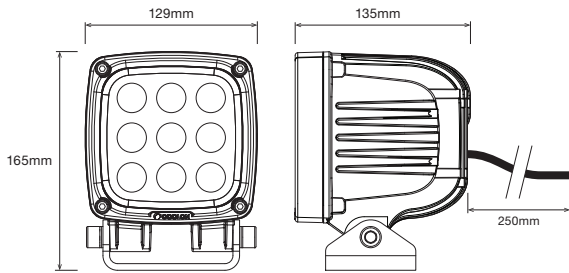

Standard Bracket

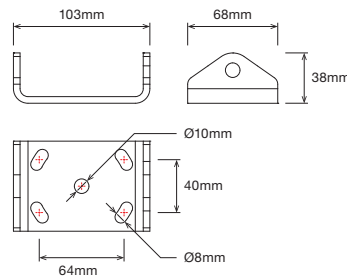

Optional Clip-on Cover

ACC-CP9-COVER (available separately)



CONFIGURATION

ELV Extra Low Voltage

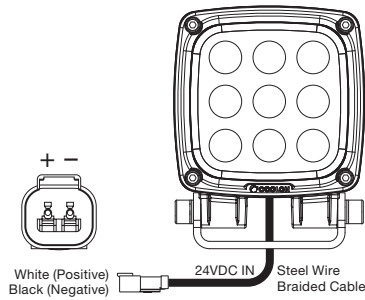

DIM 0 – 10V Dimming

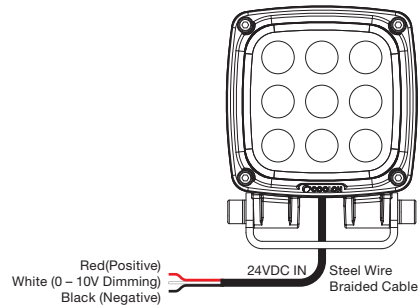

TECHNICAL SPECIFICATIONS

Product	CP9 LED Flood Light	
Model	CP9-48	CP9-60
Optical Characteristics		
Luminous Flux (Photometered)	3,591 – 4,483 lm	4,508 – 5,577 lm
Luminous Flux (LED Lumens)	5,800 lm	7,000 lm
CCT	CWT	
CRI	>70	
Electrical Characteristics (Luminaire)		
Power Consumption	48W @ 24VDC	60W @ 24VDC
Nominal Voltage	24VDC	
Voltage Range	22 – 31VDC	
Cable Type (ELV)	UL2517, 16 AWG x 2C Braid PVC, UV Resistant	
Cable Type (DIM)	UL2517, 14 AWG x 2C + 18 AWG x 1C Braid PVC, UV Resistant	
Cable Diameter	7.5mm	
Cable Length	250mm	

Environmental	
IP Rating	IP66
Impact Rating	IK09 - Grilamid TR (CP9-48) IK07 - Borosilicate Glass (CP9-60)
Salt Spray Tested	Yes
Operating Temp. Range	-20 to +50°C
Thermal Management Type	Active/Continuous
Expected Lifespan	50,000 Hours to 70% Brightness
Material Composition (Body)	LM6 Aluminium Alloy (<0.1% copper content)
Material Composition (Cover)	Grilamid TR (CP9-48) / Borosilicate Glass (CP9-60)
Material Composition (Bracket)	Stainless Steel
Material Composition (Optics)	PC
Mounting/Bracket Type	Standard
Angle Adjustment	Free aiming range -30° to +30°
Weight/Packaging	
Luminaire Weight	2.1kg
Bracket Weight	0.4kg
Packaging Dimensions (CP9)	140 x 175 x 160mm
Packaged Weight (CP9)	2.7kg

Warranty

Warranty	3 years warranty as standard 5 years extended warranty optional
----------	--

POWER VS SUPPLY VOLTAGE ¹

CP9-48

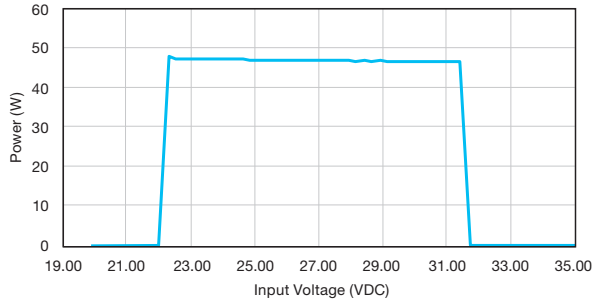

CP9-60

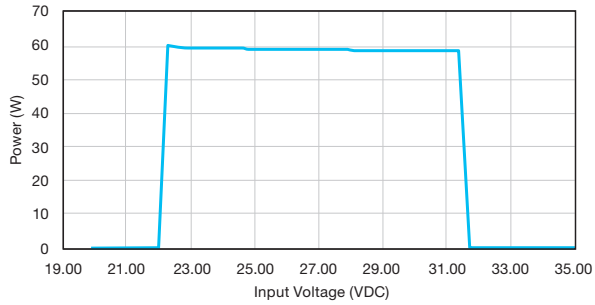

POWER VS DIMMING VOLTAGE ¹

CP9-48

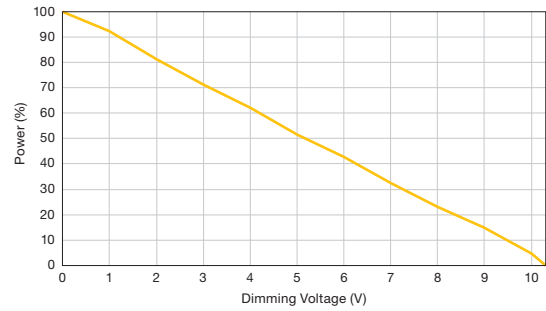

CP9-60

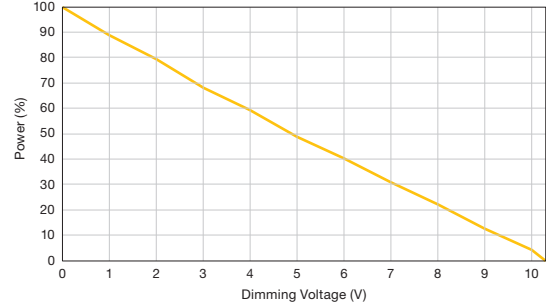

¹ Reading taken while test unit operating in steady state. Ambient temperature during testing is typically 25°C. Individual unit behavior may differ due to electronic component tolerance and ambient conditions. Product parameters and application suitability shall be checked by the user prior to commissioning.

ILLUMINANCE AT DISTANCE

NOP Extra Wide Optics

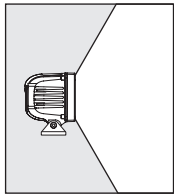

	CP9-48	CP9-60
2m	306	367
3m	131	157
5m	46	55
10m	11	13
15m	5.0	6
20m	2.8	3

E_c at Centre (Lux)

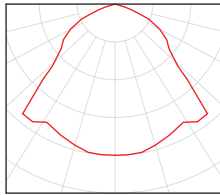

Polar Distribution

ORDERING EXAMPLE

CP9 - 48 - NOP - ELV

PRODUCT TYPE OPTICS CONFIGURATION

PRODUCT	TYPE	OPTICS	CONFIGURATION
CP9	48	Power 48W	ELV Extra Low Voltage
	60	Power 60W	DIM 3 Wires, 0 - 10V Dimming

ASSOCIATED PRODUCTS

PART #	DESCRIPTION
ACC-CP9-COVER	Optional clip-on cover