



MULTO X2

LED STRIP STR-MULTO X2





The Multo X2 LED Strip range is designed to offer the greatest versatility when it comes to colour temperature, colour LED and length options. The Multo X2 range offers a completely uniform glowing diffuser where no dots or scalloping is visible on the luminaire or the illuminated surface.

Each LED segment (300mm) features 48 LEDs and can be divided into 8 sub-segments of 37.5mm. Multo X2 range is perfect for commercial applications where precise length options are required.

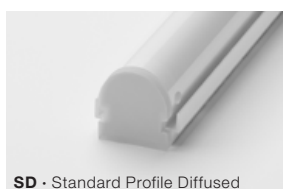

SD • Standard Profile Diffused

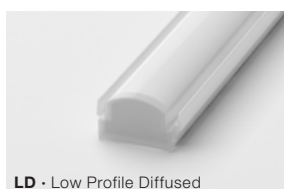

LD • Low Profile Diffused



P17D • P17 Profile Diffused

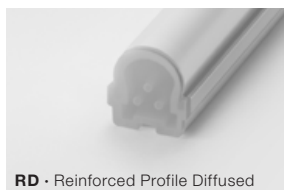

RD • Reinforced Profile Diffused

WHITE VERSION

LUMINOUS FLUX 790 – 1070 lm / metre



POWER 16W / metre



COLOUR TEMPERATURE 2200K – 6700K



COLOUR VERSION

LUMINOUS FLUX Varies with colour



POWER 16W / metre



STATIC COLOURS



*Custom colours available on request



UNIFORM GLOW

Uniform Glow denotes a uniformly illuminated diffuser. The diffuser height and the pitch of the LED is closely observed to ensure uniformity along the length of the diffuser.

HIGHLY VERSATILE LENGTH OPTIONS

Highly versatile length options allows the user to achieve much more accurate and adaptable lengths. The Multo X2 is able to achieve any desired length within a 37.5mm increment.



L70

LONG USEFUL OPERATING LIFE

Currently available specification from world's most reputable LED manufacturers states 50,000 hours of continuous operation at the rated current within the operating temperature range to 70% residual light output.



VARIOUS CCT & COLOUR BINNING CONSISTENCY

Product is offered in various Colour Temperatures using tighter bins.

3
YEARS

3 YEARS FULL /SOLID WARRANTY

Coolon Luminaires are covered by a solid comprehensible manufacturer's warranty that covers a range of possible defects and performance parameters throughout the duration of the warranty period.



PROUDLY MADE IN AUSTRALIA

Our products are designed and manufactured in Australia. Engineered to perfection, using only the highest quality components and highly skilled labour, each luminaire is assembled and thoroughly tested to ensure that it exceeds the highest standards.

TECHNICAL SPECIFICATIONS

	WHITE	BLUE	GREEN	RED	AMBER	YELLOW
Product Code	STR-MULTO X2					
Description	Multo X2 Medium Power LED Strip					
Segment Length (S)	300mm					
Sub-Segment Length (A)	37.5mm					
Number of Sub-Segments	8					
Segment Width	10.50mm					
LED Pitch	6.25mm					
LEDs Per Segment	48					
LEDs Per Sub Segment	6					
Operating Voltage	24VDC	24VDC	24VDC	24VDC	24VDC	24VDC
Typical Power Consumption per Segment	4.8W	4.8W	4.8W	4.8W	4.8W	4.8W
Typical Power Consumption per Metre	16W/m	16W/m	16W/m	16W/m	16W/m	16W/m
Typical Current	200mA	200mA	200mA	200mA	200mA	200mA
Colour Rendering Index (CRI)	80+	Not Applicable	Not Applicable	Not Applicable	Not Applicable	Not Applicable
Dimmable	Through DRV-DALIPOINT-1X5A, DRV-DALIPOINT-1X10A-IP, or DRV-DIMMERPOINT-1X10A (sold separately)					
Effective Beam Angle	120°					
External Heatsink Required	No					
Ambient Operating Temp	Ta -40°C to 50°C					
Thermal Management	No					
Average Lumen Maintenance @Ta 25°C	70% @ 50,000 Hours					
IP Rating	IP40 (Standard), up to IP68					
Max Continuous Connection Length	Please refer to installation limitations					
Wavelength	Not Applicable	469nm	525nm	633nm	603/617nm	587nm

COLOUR BINNING (WHITE)

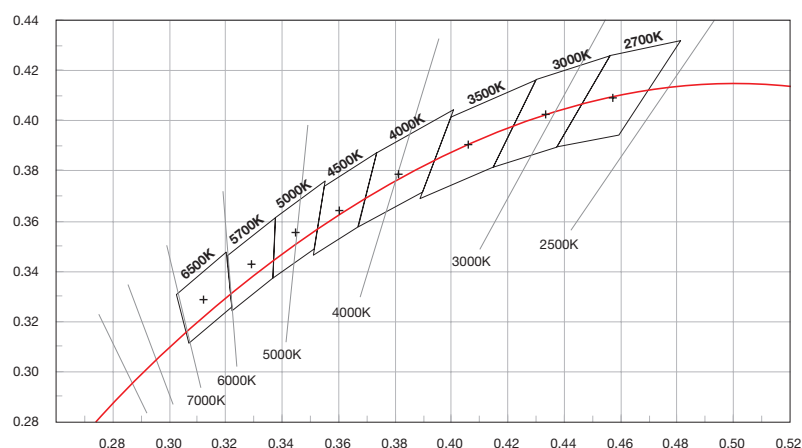

DIMENSIONS

For final strip lengths please refer to the "Product Length" table.

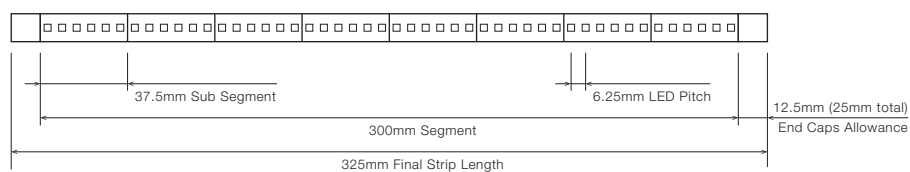

STANDARD PROFILE

Available in Clear and Diffused

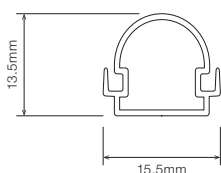

WITH MOUNTING CLIP

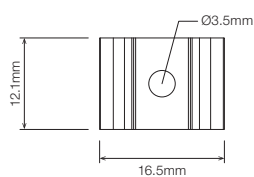
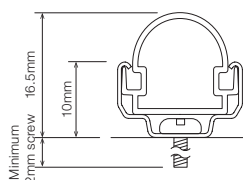

RECOMMENDED REBATE

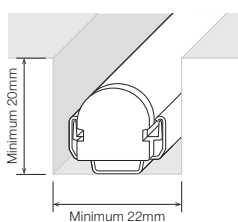

LOW PROFILE

Available in Clear and Diffused

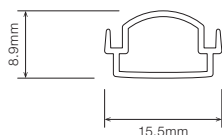

WITH MOUNTING CLIP

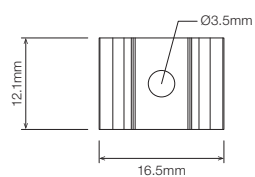
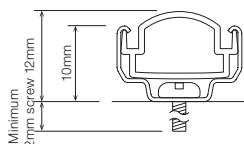

RECOMMENDED REBATE

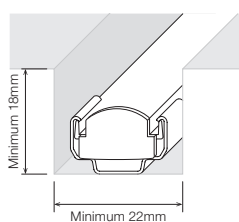

REINFORCED PROFILE

Available in Diffused

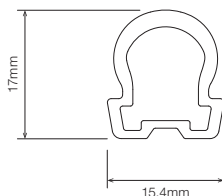

WITH MOUNTING CLIP

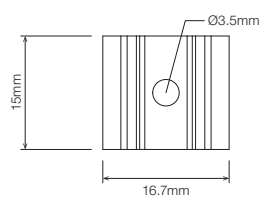
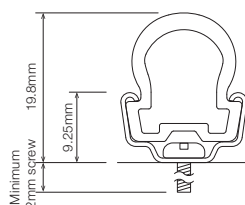

RECOMMENDED REBATE

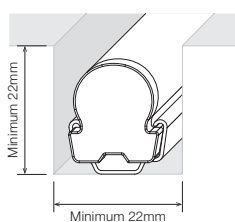

P17 PROFILE

Available in Clear and Diffused (IP40 only)

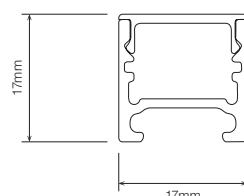

WITH MOUNTING X-CLIP

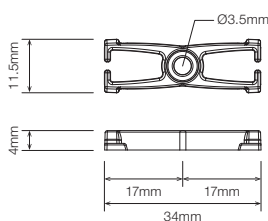
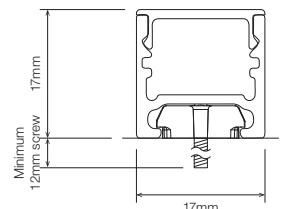

WITH ROTATING CLIP

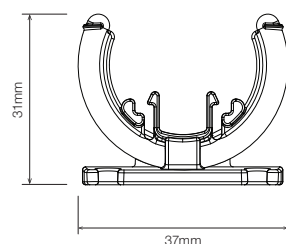
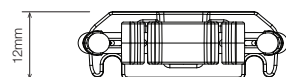
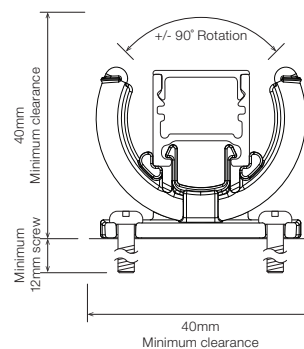

PRODUCT LENGTH

FULL SEGMENTS	SUB SEGMENTS	EXACT STRIP LENGTH	END CAP ALLOWANCE	FINAL LENGTH
0	1	37.5mm	add 25mm	62.5mm
0	2	75mm	add 25mm	100mm
0	3	112.5mm	add 25mm	137.5mm
0	4	150mm	add 25mm	175mm
0	5	187.5mm	add 25mm	212.5mm
0	6	225mm	add 25mm	250mm
0	7	262.5mm	add 25mm	287.5mm
1	0	300mm	add 25mm	325mm
1	1	337.5mm	add 25mm	362.5mm
1	2	375mm	add 25mm	400mm
1	3	412.5mm	add 25mm	437.5mm
1	4	450mm	add 25mm	475mm
1	5	487.5mm	add 25mm	512.5mm
1	6	525mm	add 25mm	550mm
1	7	562.5mm	add 25mm	587.5mm
2	0	600mm	add 25mm	625mm
2	1	637.5mm	add 25mm	662.5mm
2	2	675mm	add 25mm	700mm
2	3	712.5mm	add 25mm	737.5mm
2	4	750mm	add 25mm	775mm
2	5	787.5mm	add 25mm	812.5mm
2	6	825mm	add 25mm	850mm
2	7	862.5mm	add 25mm	887.5mm
3	0	900mm	add 25mm	925mm
3	1	937.5mm	add 25mm	962.5mm
3	2	975mm	add 25mm	1,000mm
3	3	1,012.5mm	add 25mm	1,037.5mm
3	4	1,050mm	add 25mm	1,075mm
3	5	1,087.5mm	add 25mm	1,112.5mm
3	6	1,125mm	add 25mm	1,150mm
3	7	1,162.5mm	add 25mm	1,187.5mm
4	0	1,200mm	add 25mm	1,225mm
4	1	1,237.5mm	add 25mm	1,262.5mm
4	2	1,275mm	add 25mm	1,300mm
4	3	1,312.5mm	add 25mm	1,337.5mm
4	4	1,350mm	add 25mm	1,375mm
4	5	1,387.5mm	add 25mm	1,412.5mm
4	6	1,425mm	add 25mm	1,450mm
4	7	1,462.5mm	add 25mm	1,487.5mm
5	0	1,500mm	add 25mm	1,525mm

Continued on next page

⚠ WARNING

Do not bend LED strip when removing from mounting clips.

Gently twist LED Strip to remove from mounting clips.

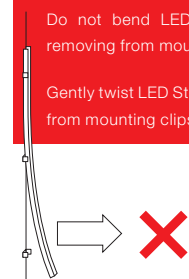

⚠ WARNING

PLEASE HANDLE LONG LED STRIPS WITH CARE.

LED Strips must not be bent.

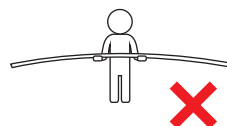

When handling LED Strips, please ensure that they are kept straight.

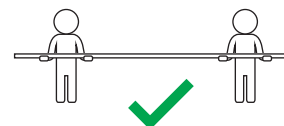

PRODUCT LENGTH

(CONTINUED)

FULL SEGMENTS	SUB SEGMENTS	EXACT STRIP LENGTH	END CAP ALLOWANCE	FINAL LENGTH
5	1	1,537.5mm	add 25mm	1,562.5mm
5	2	1,575mm	add 25mm	1,600mm
5	3	1,612.5mm	add 25mm	1,637.5mm
5	4	1,650mm	add 25mm	1,675mm
5	5	1,687.5mm	add 25mm	1,712.5mm
5	6	1,725mm	add 25mm	1,750mm
5	7	1,762.5mm	add 25mm	1,787.5mm
6	0	1,800mm	add 25mm	1,825mm
6	1	1,837.5mm	add 25mm	1,862.5mm
6	2	1,875mm	add 25mm	1,900mm
6	3	1,912.5mm	add 25mm	1,937.5mm
6	4	1,950mm	add 25mm	1,975mm
6	5	1,987.5mm	add 25mm	2,012.5mm
6	6	2,025mm	add 25mm	2,050mm
6	7	2,062.5mm	add 25mm	2,087.5mm
7	0	2,100mm	add 25mm	2,125mm
7	1	2,137.5mm	add 25mm	2,162.5mm
7	2	2,175mm	add 25mm	2,200mm
7	3	2,212.5mm	add 25mm	2,237.5mm
7	4	2,250mm	add 25mm	2,275mm
7	5	2,287.5mm	add 25mm	2,312.5mm
7	6	2,325mm	add 25mm	2,350mm
7	7	2,362.5mm	add 25mm	2,387.5mm
8	0	2,400mm	add 25mm	2,425mm
8	1	2,437.5mm	add 25mm	2,462.5mm
8	2	2,475mm	add 25mm	2,500mm
8	3	2,512.5mm	add 25mm	2,537.5mm
8	4	2,550mm	add 25mm	2,575mm
8	5	2,587.5mm	add 25mm	2,612.5mm
8	6	2,625mm	add 25mm	2,650mm
8	7	2,662.5mm	add 25mm	2,687.5mm
9	0	2,700mm	add 25mm	2,725mm
9	1	2,737.5mm	add 25mm	2,762.5mm
9	2	2,775mm	add 25mm	2,800mm
9	3	2,812.5mm	add 25mm	2,837.5mm
9	4	2,850mm	add 25mm	2,875mm
9	5	2,887.5mm	add 25mm	2,912.5mm
9	6	2,925mm	add 25mm	2,950mm
9	7	2,962.5mm	add 25mm	2,987.5mm

Confirm Interstate Courier Compliance

Custom Length subject to availability

⚠ WARNING

Do not bend LED strip when removing from mounting clips.

Gently twist LED Strip to remove from mounting clips.

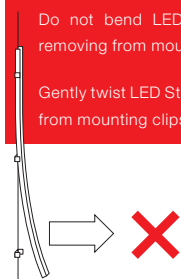

⚠ WARNING

PLEASE HANDLE LONG LED STRIPS WITH CARE.

LED Strips must not be bent.

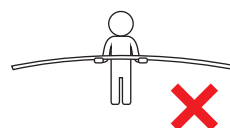

When handling LED Strips, please ensure that they are kept straight.

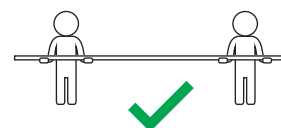

■ PROFILE / DIFFUSER

SD • Standard Profile Diffused



LD • Low Profile Diffused

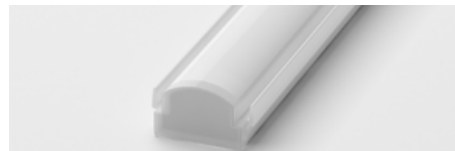

P17D • P17 Profile Diffused *



Provides completely uniform glow along the length of the diffuser

RD • Reinforced Profile Diffused

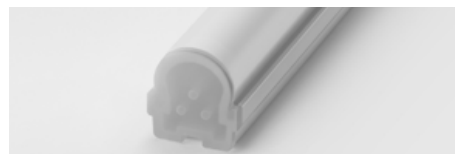

■ CUSTOMISED PROFILE

MC-P17CNR • P17 Corner Joiner



■ PROFILE COLOUR

Profile colour applicable to P17 only.

WHT • White (Standard)



BLK • Black















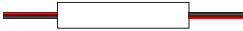











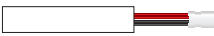

CST • Custom Colour **

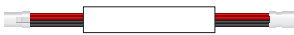

* P17 Profile available in IP40 only.

** Custom colours available on request.

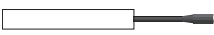
■ WIRING CONFIGURATION

CONNECTOR TYPE	DRAWING	FEMALE	MALE
WR2OS Wire 2 Core One Side			
WR2BS Wire 2 Core Both Sides			
WR4OS Wire 4 Core One Side			
WR4BS Wire 4 Core Both Sides			
OC2MO Outdoor Connector 2pin Male Only			
OC2FO Outdoor Connector 2pin Female Only			
OC2MF Outdoor Connector 2pin Male + Female			
OC4MO Outdoor Connector 4pin Male Only			
OC4FO Outdoor Connector 4pin Female Only			
OC4MF Outdoor Connector 4pin Male + Female			
SMPLC Sample Type Connector 2.5mm 			

WIRING COLOUR CODE	
Red	+ VDC
Black	GND

■ IP RATING

IP40 *

Protected against solid objects greater than 1mm. No protection against liquids.

IP65

Fully protected against dust. Protected against water jets from all directions

IP68

Fully protected against dust. Protected against the effects of prolonged immersion under water.

* P17 Profile available in IP40 only.

■ INSTALLATION LIMITS

SCENARIO 1

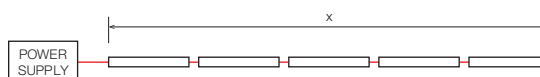

SCENARIO 2

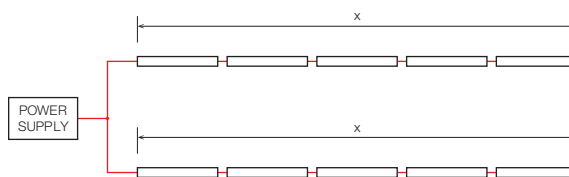

SCENARIO 3

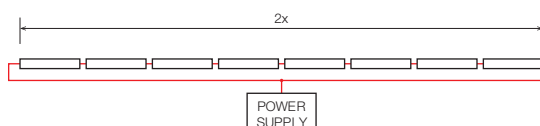

MAX. CONTINUOUS CONNECTION LENGTH (X) CONNECTOR TYPE

8,000 mm	With standard 2 core (WR2OS / WR2BS)
9,200 mm	With upgraded 4 core (WR4OS / WR4BS)
3,400 mm	With upgraded outdoor 2 pin connectors (OC2MO / OC2FO / OC2MF)
5,800 mm	With upgraded outdoor 4 pin connectors (OC4MO / OC4FO / OC4MF)

- Please consult Coolon for details on extension cable between LED fittings, drivers and power supplies.

⚠ WARNING

Avoid connecting multiple power supplies into a single circuit, unless they are specifically designed to do so.

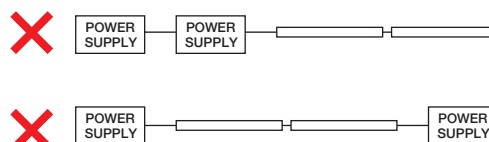

ORDERING EXAMPLE

STR - MULTO X2 - 3.1K - S2A0 - P17D - WHT - WR2BS - 100 - IP40

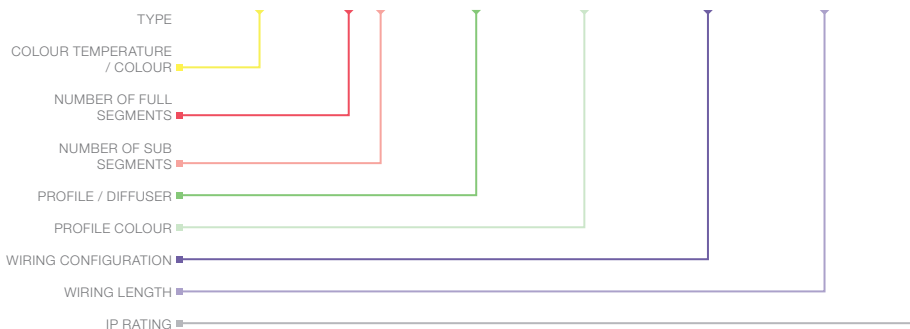

■ COLOUR TEMPERATURE * PAGE 04

2.2K	2200K
2.5K	2500K
2.7K	2700K
2.9K	2900K
3.1K	3100K
3.9K	3900K
4.2K	4200K
4.7K	4700K
5.2K	5200K
6.7K	6700K

■ COLOUR

BL	Blue
GR	Green
RD	Red
AM	Amber
YL	Yellow

■ PRODUCT LENGTH PAGE 06

FULL SEGMENTS	SUB SEGMENTS
S1	A0
S2	A1
S3	A2
S4	A3
S5	A4
S6	A5
S7	A6
S8	A7
S9	

■ PROFILE / DIFFUSER PAGE 08

SD	Standard Profile Diffused
LD	Low Profile Diffused
RD	Reinforced Profile Diffused
P17D	P17 Profile Diffused

■ PROFILE COLOUR ** PAGE 08

WHT	White (Standard)
BLK	Black
CST	Custom Colour

■ WIRING CONFIGURATION PAGE 09

WR2OS	Wire 2 Core One Side
WR2BS	Wire 2 Core Both Sides
WR4OS	Wire 4 Core One Side
WR4BS	Wire 4 Core Both Sides
OC2MO	Outdoor Connector 2 pin Male Only
OC2FO	Outdoor Connector 2 pin Female Only
OC2MF	Outdoor Connector 2 pin Male + Female
OC4MO	Outdoor Connector 4 pin Male Only
OC4FO	Outdoor Connector 4 pin Female Only
OC4MF	Outdoor Connector 4 pin Male + Female
SMPLC	Sample Type Connector 2.5mm

■ WIRING LENGTH PAGE 09

100	100mm
250	250mm
500	500mm
1000	1000mm

■ IP RATING *** PAGE 09





IP40	Indoor Use
IP65	Outdoor Use
IP68	Prolonged Immersion Use

* Other CCT subject to availability.

** Profile colour applicable to P17 only. Custom colours available on request.

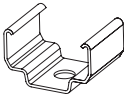
*** P17 Profile available in IP40 only.

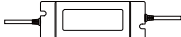
■ ACCESSORIES

	PRODUCT CODE	DESCRIPTION
MOUNTING CLIP		
	MC-1513	Stainless Steel Mounting Clips for Standard & Low Profile
	MC-RD	Stainless Steel Mounting Clips for Reinforced Profile
	MC-XCLIP	Flat Mount X-clip
	MC-P17R	Rotating Clip Mount for P17 Profile
	MC-P17CNR	P17 Corner Joiner
DRIVER		
	DRV-DIMMERPOINT-1X10A	Rotary Wall-Mount LED Driver
	DRV-DALIPOINT-1X5A	Indoor DALI Point 1 channel Driver 5A
	DRV-DALIPOINT-IP1X10A	Outdoor DALI Point 1 channel Driver 10A
POWER SUPPLY FOR INDOOR USE		
	PWR-PLN20-24V	Mean Well Power Supply PLN 20W 24V IP64 + Flex & Plug
	PWR-PLN30-24V	Mean Well Power Supply PLN 30W 24V IP64 + Flex & Plug
	PWR-PLN60-24V	Mean Well Power Supply PLN 60W 24V IP64 + Flex & Plug
	PWR-PLN100-24V	Mean Well Power Supply PLN 100W 24V IP64 + Flex & Plug
POWER SUPPLY FOR OUTDOOR USE (IP67)		
	PWR-HLG40-24V	Mean Well Power Supply HLG 40W 24V IP67
	PWR-HLG60-24V	Mean Well Power Supply HLG 60W 24V IP67
	PWR-HLG100-24V	Mean Well Power Supply HLG 100W 24V IP67
	PWR-HLG150-24V	Mean Well Power Supply HLG 150W 24V IP67
	PWR-HLG185-24V	Mean Well Power Supply HLG 185W 24V IP67
	PWR-HLG240-24V	Mean Well Power Supply HLG 240W 24V IP67
	PWR-HLG320-24V	Mean Well Power Supply HLG 320W 24V IP67